

Project

Ashbourne SHD

Report Title

Mobility Management Plan

Client

Arnub Ltd. & Aspect Homes (ADC) Ltd

TRANSPORTATION

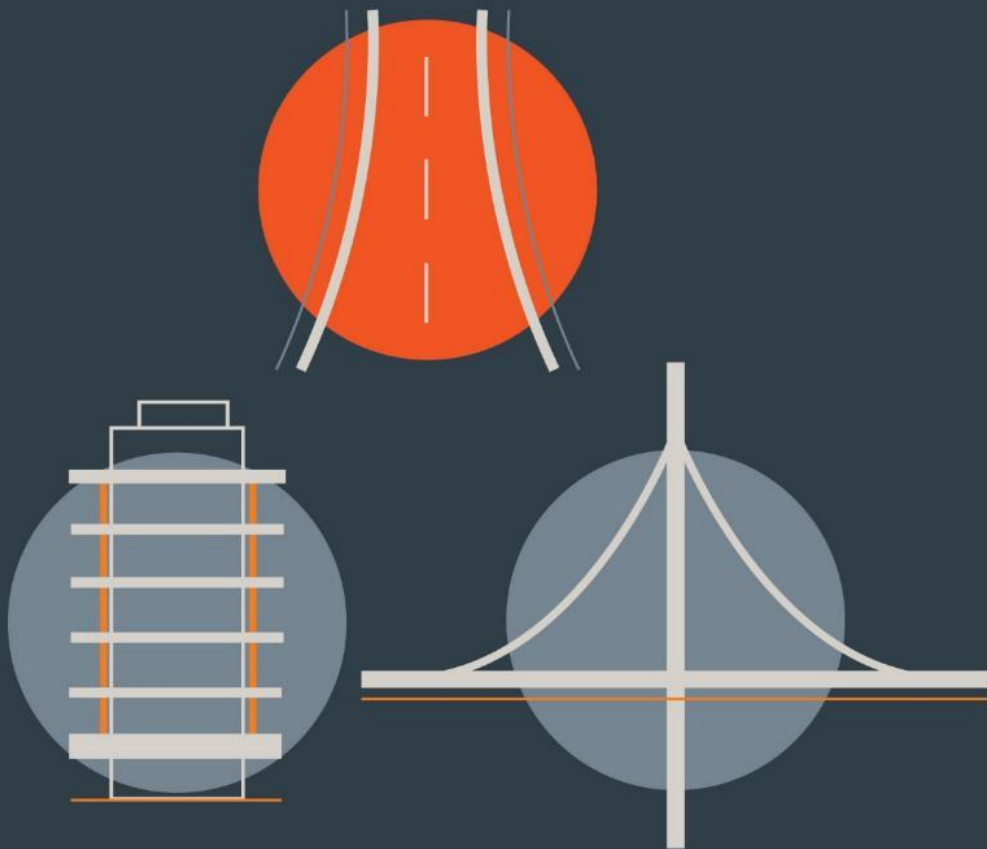

DBFL CONSULTING ENGINEERS

September 2022

Document Control

Job Title: Ashbourne SHD

Job Number: p200059

Report Ref: 200059-DBFL-XX-XX-RP-0005-MMP

Author: Enrique Marenco Jimenez

Reviewed by: Mark Kelly

Date: September 2022

Distribution: DBFL Consulting Engineers
Client
Planning Authority

Revision	Issue Date	Description	Prepared	Reviewed	Approved
1 st Draft	13/12/2021	Draft	EMJ	MPK	-
Final	15/12/2021	SHD Stage 2 Planning	EMJ	MPK	RK
Rev A	29/08/2022	SHD Stage 3 Draft	SAS	MPK	RK
Rev B	02/09/2022	SHD Stage 3 Final	EMJ	MPK	RK

DBFL Consulting Engineers

Dublin Office

Ormond House
Ormond Quay
Dublin 7

Tel 01 4004000

Fax 01 4004050

Email info@dbfl.ie

Web www.dbfl.ie

Waterford Office

The Atrium
Maritana Gate
Canada Street
Waterford

Tel 051 309500

Email info@dbfl.ie

Web www.dbfl.ie

Cork Office

14 South Mall
Cork
T12 CT91

Tel 021 2024538

Email info@dbfl.ie

Web www.dbfl.ie

This document has been prepared for the exclusive use of our Client and unless otherwise agreed in writing with DBFL Consulting Engineers, no other party may use, make use of, or rely on the contents of this document. The document has been compiled using the resources agreed with the Client, and in accordance with the agreed scope of work. DBFL Consulting Engineers accepts no responsibility or liability for any use that is made of this document other than for the purposes for which it was originally commissioned and prepared, including by any third party, or use by others, of opinions or data contained in this document. DBFL Consulting Engineers accepts no liability for any documents or information supplied by others contained or referenced in this document. It is expressly stated that no independent verification of any documents or information supplied by others for this document has been made. DBFL Consulting Engineers has used reasonable skill, care, and diligence in compiling this document. It should be noted that no changes of whatsoever nature are to be made to any wording, information or details set out or contained in any DBFL document unless the express consent has been obtained in advance, in writing, from DBFL.

CONTENTS

1	
1.0 INTRODUCTION	2
1.1 CONTEXT	2
1.2 BACKGROUND	3
1.3 STRUCTURE OF REPORT	4
2.0 MOBILITY MANAGEMENT PLAN FRAMEWORK	7
2.1 WHAT IS A MOBILITY MANAGEMENT PLAN?	7
2.2 WHAT IS A RESIDENTIAL MOBILITY MANAGEMENT PLAN?	7
2.3 WHO IS INVOLVED?	8
2.4 OBJECTIVES OF A MOBILITY MANAGEMENT PLAN	9
2.5 MOBILITY MANAGEMENT PLAN PROCESS	9
2.6 MOBILITY MANAGEMENT PLAN NEXT STEP	11
2.7 POLICY FRAMEWORK	12
3.0 PROPOSED DEVELOPMENT	24
3.1 RECEIVING ENVIRONMENT	24
3.2 PROPOSED DEVELOPMENT	24
4.0 COMMUTER TRENDS & TRANSPORT NEEDS	30
4.1 INTRODUCTION	30
4.2 GREATER DUBLIN AREA CONTEXT	30
4.3 LOCAL STUDY AREA CONTEXT	32
5.0 OBJECTIVES & TARGETS	36
5.1 INTRODUCTION	36
5.2 MMP OBJECTIVES	36
5.3 MMP ACTIONS & TARGETS	37
6.0 MMP MEASURES	41
6.1 INTRODUCTION	41
6.2 MODE SPECIFIC MEASURES	42
6.3 MANAGEMENT & MONITORING MEASURES	42
6.4 MARKETING & PROMOTION MEASURES	43
7.0 PRELIMINARY ACTION PLAN	45
7.1 OVERVIEW	45
7.2 MANAGEMENT AND MONITORING STRATEGY	45
7.3 WALKING STRATEGY	49

7.4	CYCLING STRATEGY	51
7.5	PUBLIC TRANSPORT STRATEGY	53
7.6	PRIVATE CAR STRATEGY	55
7.7	MARKETING AND PROMOTION STRATEGY	57
8.0	SUMMARY AND CONCLUSIONS	60
8.1	SUMMARY	60

APPENDICES

Appendix A	Mode Specific Measures
Appendix B	Management & Monitoring Measures
Appendix C	Marketing & Promotion Measures



1.1 CONTEXT

1.2 BACKGROUND

1.3 STRUCTURE OF REPORT

1.0 INTRODUCTION

1.1 CONTEXT

- 1.1.1 DBFL Consulting Engineers have compiled this framework Mobility Management Plan (MMP) as part of the planning application for a proposed residential development at a site located on Cherry Lane, Ashbourne, Co. Meath.
- 1.1.2 Arnub Ltd. & Aspect Homes (ADC) Ltd. seek permission for a strategic housing development, located in the townlands of Baltrasna and Milltown, Ashbourne, Co. Meath. The proposed development site is located to the west of the R135 Dublin Road, south of existing housing at Alderbrook Rise, Alderbrook Downs & Alderbrook Heath, east of existing housing at Tara Close & Tara Court, south of Cherry Lane and west of Hickey's Lane.
- 1.1.3 The development will consist of 702 no. dwellings, comprised of 420 no. 2 & 3 storey, 2, 3, 4 & 5 bed houses, 39 no. 2 & 3 bed duplex units in 19 no. blocks, and 243 no. 1, 2 & 3 bed apartments in 20 no. buildings, which range in height from 3, 3-4, 4-5, & 4-6 storeys. The proposed development also provides for the following uses: (i) 2 no. creches (c.288.56m² & 383.68m²) accommodated in Blocks A and A1 respectively, (ii) 4 no. retail/commercial units (c. 105.58 m² & 173.83m² in Block A, c.190.6m² in Block A1 & c.469m² in Block B1) and (iii) GP practice / medical use unit (c.186m²) in Block A1.
- 1.1.4 Access to the development will be via (i) Cherry Lane to the north-east, off the R135 Dublin Road, via a new proposed internal access road and (ii) via Hickey's Lane to the east, off the R135 Dublin Road, including pedestrian and cycle paths.
- 1.1.5 The proposed development provides for (i) all ancillary / associated site development works above and below ground, (ii) public open spaces, including hard & soft landscaping, play equipment & boundary treatments, (iii) communal open spaces, (iv) undercroft, basement & surface car parking (v) bicycle parking (vi) bin storage, (vii) public lighting, (viii) plant (M&E), utility services & ESB sub-stations, all on an overall application site area of 20.04Ha.
- 1.1.6 The proposed development also includes for an area of c. 1Ha reserved for a school site and playing pitch in the western part of the site. Permission is also sought to demolish all existing structures on site, i.e. 3 no. single storey dwellings & associated out-buildings (659m² in total).

1.1.7 This MMP has been prepared to guide the delivery and management of several coordinated initiatives which ultimately seek to encourage sustainable travel practices for all journeys to and from the proposed residential development.

1.1.8 This framework document aims to inform three distinct audiences as follows;

- The appointed **Mobility Manager** who will be responsible for implementing and managing the MMP. The MMP targets and measures introduced in Chapter 5 and Chapter 6 will be coordinated, administered and updated by the appointed Mobility Manager.
- The **Local Authority Officers** who will be eager to ensure that the MMP initiatives are appropriately ambitious, deliverable and implemented fully. The officers, who will be very familiar with the MMP process, will be predominately interested in the proposed MMP Targets (**Chapter 5**) and associated measures (**Chapter 6**).
- The **Residents** of the proposed development who may be unfamiliar with the MMP process. They will find the process and context information as outlined in **Chapter 2** invaluable. They may also be interested in the MMP targets and measures introduced in **Chapter 5** and **Chapter 6**.

1.2 BACKGROUND

1.2.1 This Mobility Management Plan (MMP) has been prepared to guide the delivery and management of a package of integrated initiatives which seek to encourage sustainable travel practises at the proposed residential development located at Cherry Lane, Ashbourne. This document aims to expand the awareness of and increase travel options and mobility opportunities for the residents located at the site. The Plan will be used mainly by the appointed Mobility Manager who will be responsible for implementing and managing the MMP for the benefits of the residents who may be interested in reading this document to see how it directly affects them.

1.2.2 This Framework MMP has been prepared to guide the delivery and management of a package of integrated initiatives which ultimately seek to encourage sustainable travel practices of all residents and visitors travelling to/from the proposed residential development on Cherry Lane, Ashbourne, Co. Meath.

1.2.3 The purpose of the Mobility Management Plan is to:

- Provide a 'manual' and record for the Mobility Manager who will be appointed to oversee the implementation and development of the measures set out in the document,
- A formal record for the local authority in regard to the type, scale and number of initiatives that the MMP initially proposes and subsequently their level of success in subsequent versions of the MMP which remains a 'live' document to be updated at least initially every 2 to 3 years following its implementation, and
- The MMP will seek to provide a long-term strategy for encouraging residents and visitors to reduce their dependency on travelling by car in favour of more sustainable modes of travel.

1.2.4 The aims of the strategy are:

- (a) to increase the awareness of residents, staff and visitors to all the transport options available to them and to the potential for travel by more sustainable modes, and
- (b) to introduce a package of both 'hard' (physical) and 'soft' (behavioural) measures that will facilitate travel by sustainable modes of travel to/from the subject residential development.

1.3 STRUCTURE OF REPORT

1.3.1 Following this introduction, the MMP framework including the definition of a MMP, its objectives, the scope and process involved in compiling and implementing such a plan is outlined in **Chapter 2**.

1.3.2 The environment within which the proposed residential development MMP is placed, such as location and local transportation system is briefly outlined in **Chapter 3**.

1.3.3 The MMP context in terms of local travel trends and 2016 census data are established in **Chapter 4**.

1.3.4 The MMP objectives and targets are established in **Chapter 5**.

1.3.5 In **Chapter 6** the measures and travel initiatives selected to encourage sustainable travel are discussed. These include Mode Specific Measures, Management Measures, Marketing Measures and Monitoring & Review Measures.

- 1.3.6 With the objective of establishing the basis for discussions with the local authority, from which an agreed MMP action plan can be adopted, **Chapter 7** presents a Preliminary Action Plan for the MMP at the residential development at Milltown.
- 1.3.7 The main conclusions and recommendations of the MMP are summarised in **Chapter 8**.



CHAPTER 2

Mobility Management Plan Framework

- 2.1 What is a Mobility Management Plan?**
- 2.2 What is a Residential MMP?**
- 2.3 Who is Involved?**
- 2.4 Objectives of an MMP**
- 2.5 MMP Process**
- 2.6 MMP Next Step**
- 2.7 Policy Framework**

2.0 MOBILITY MANAGEMENT PLAN FRAMEWORK

2.1 WHAT IS A MOBILITY MANAGEMENT PLAN?

2.1.1 The Dublin Transportation Office's (which has been subsumed into the National Transportation Authority (NTA) in December 2009) 2001 publication entitled "*The Route to Sustainable Commuting*" defines a MMP as "... a package of measures put in place by an organisation to encourage and support more sustainable travel patterns ...".

2.1.2 The MMP can be developed for an individual site or group of sites and designed specially to respond to a range of different site-specific land uses such as business (offices, retail, industrial etc.), residential and schools/ colleges/ universities.

2.1.3 Whilst the emergence and successful application of MMPs have only transpired over the last 15 years in Ireland, other countries have extensive experience in designing, implementing, marketing and monitoring the successful delivery of MMPs. Accordingly, MMPs are also known by a number of other names including:

- Travel Plans;
- Green Travel Plans;
- Sustainable Mobility Plans; or
- Sustainable Commuter Plans.

2.2 WHAT IS A RESIDENTIAL MOBILITY MANAGEMENT PLAN?

2.2.1 A Residential Mobility Management Plan is a package of measures designed specifically to reduce the number and length of car-based trips generated, whilst also encouraging more sustainable forms of travel and reducing the overall need to travel. It sets out objectives and targets to achieve sustainable travel patterns.

2.2.2 A successfully implemented Residential MMP can provide reductions in car usage, particularly influencing levels of single-occupancy car travel, with increased trips made by public transport, walking and cycling; and improve road safety and personal security (especially for pedestrians and cyclists).

2.2.3 Mobility Management Plans to date have mainly focused on the development of destination MMPs and to encourage travel by sustainable modes for employment and school developments. Destination MMPs focus on a particular journey purpose

while a residential MMP is concerned with journeys made from a single origin (home) to multiple and changing destinations.

2.2.4 Best Practise guidance is provided in "*Making Residential Travel Plans Work – Good Practice Guidelines For New Development*" published by the Department for Transport (UK) in September 2005 and "*Making Residential Travel Plans Work*" in August 2007. These documents highlight that a Residential MMP will be different to a school or workplace MMP as the pattern of journeys originating at a place of residence is more varied with multiple destinations and different needs and travel choices.

2.2.5 The DfT's (UK) "*Making Residential Travel Plans Work – Good Practice Guidelines*" suggest that the growing interest in residential travel planning is being driven by two factors:

- *"the increased acceptance of travel planning as a legitimate part of the transport planning toolkit and an effective mechanism in helping both to reduce congestion and to promote the use of sustainable modes of transport"*
- *"the pressure for new housing and its transport implications in many parts of the country is driving the need to find new ways of ensuring the development of more sustainable communities"*

2.3 WHO IS INVOLVED?

2.3.1 A Residential MMP impacts the following stakeholders who should all be involved in some form or manner:

- Local Authority Officers;
- Housing developers;
- Future residents at sites that have an MMP;
- Residents in the community surrounding new housing developments with a MMP; and
- Transport Operators.

2.4 OBJECTIVES OF A MOBILITY MANAGEMENT PLAN

- 2.4.1 The principal objective of an MMP is to reduce levels of private car use in parallel with encouraging people to walk, cycle, use public transport, car share or even reduce the number trips undertaken / required.
- 2.4.2 A comprehensive range of goals, and subsequent complementary secondary level objectives, can be identified with the purpose of achieving the ultimate objective of the MMP. This can be achieved through the delivery of a range of complimentary integrated initiatives which can positively influence travel behaviour and associated travel habits.
- 2.4.3 The specific objective(s) of an MMP can vary depending upon the organisation, site characteristics and specific land uses which vary with each site. Nevertheless, in the context of this MMP objectives can include;
- a) For the Residents –
 - Address residents' need for access to a full range of facilities for work, education, health, leisure, recreation and shopping; and
 - Promote healthy lifestyles and sustainable, vibrant local communities.
 - b) The Local Community –
 - Reduce the traffic generated by the development for journeys on the external road network;
 - Make local streets less dangerous, less noisy and less polluted;
 - Enhance viability of public transport; and
 - Improve the environment and the routes available for cycling and walking.

2.5 MOBILITY MANAGEMENT PLAN PROCESS

- 2.5.1 Once the decision has been made to produce a MMP the process of compiling the plan encompasses the 9 principal steps presented in **Figure 2.1** below.
- 2.5.2 The MMP however remains an 'active' document which continues to evolve and develop during its lifecycle. Accordingly, once the initial nine steps have been successfully completed (including monitoring and reporting requirements), the process recommences with the identification of new actions and associated targets

which instigates the second generation of the MMP. As a result, subsequent generations of the MMP can be incorporated into the management and operation of the residential development for as long as necessary or potentially even for the entire existence of the residential development.

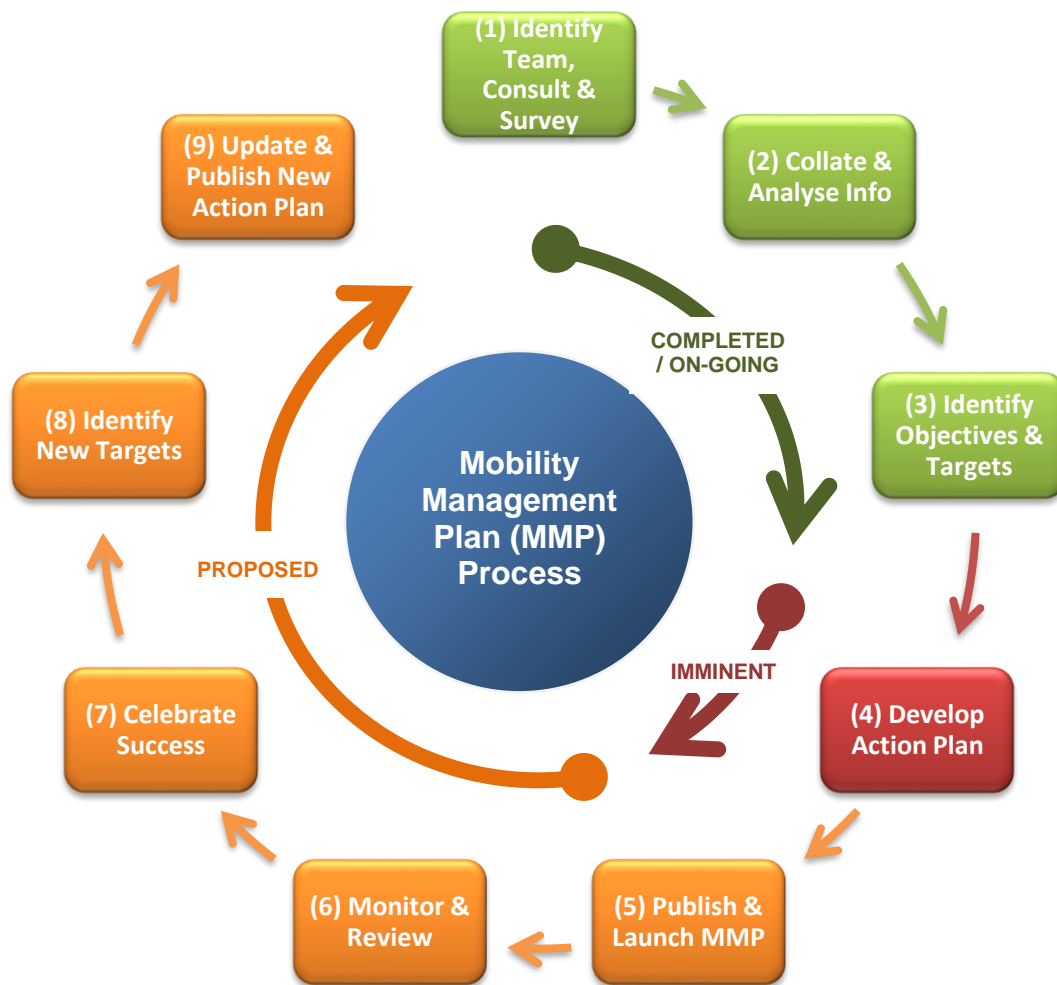

Figure 2.1: MMP Development Process and Status

2.5.3 Once the Residential development’s specific objectives are identified “SMART” targets will both assist in defining the specific measures that are included and / or prioritised within the MMP (to reach the objective), and help with the monitoring and evaluation of the level of success achieved by the MMP. SMART targets, which can be agreed with the local authority should be;

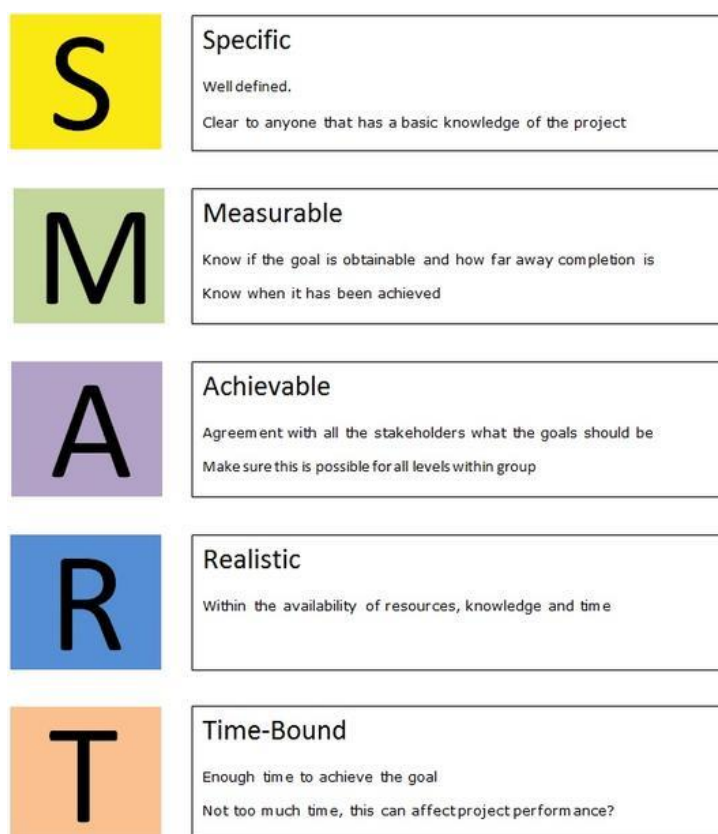

Figure 2.2: SMART targeting principles

2.6 MOBILITY MANAGEMENT PLAN NEXT STEP

2.6.1 In the context of the residential development's operational framework, the local receiving environment and the identification of the Preliminary Action Plan this document should form the basis by which;

- (a) the subject residential accommodation development's specific travel characteristics are outlined and presented to the local authority; and
- (b) through a partnership approach between the developers and the local planning authority, the Preliminary Action Plan is explored and re-examined with the objective of reaching agreement upon the MMP's measures and subsequently the adoption of an 'agreed' MMP Action Plan with targets, initiatives, timescales, responsibilities and resources clearly outlined and approved by both parties.

2.6.2 To enable this process to commence it is proposed that this MMP framework document, as compiled by DBFL is submitted to Meath County Council once

permission is granted by An Bord Pleanála. At the request of the local authority a meeting between the local authority officers and the developers can take place if required with the objective of formally agreeing an MMP action plan and associated targets for the subject residential development as proposed at Cherry Lane, Ashbourne, Co. Meath.

2.7 POLICY FRAMEWORK

2.7.1 The MMP for the residential development is supported by comprehensive transport policy hierarchy in addition to being influenced directly / indirectly by other policy themes (e.g. environmental, health etc.) which generate a range of complementary policy instruments in addition to demands and pressures that clearly necessitate a change in existing travel behaviour. Commencing at EU level and subsequently transferred into national policy and regulations in Ireland the hierarchy continues from regional (Greater Dublin Area) to sub-region (Meath County Council) and eventually arriving at site (or land use) specific policy objectives.

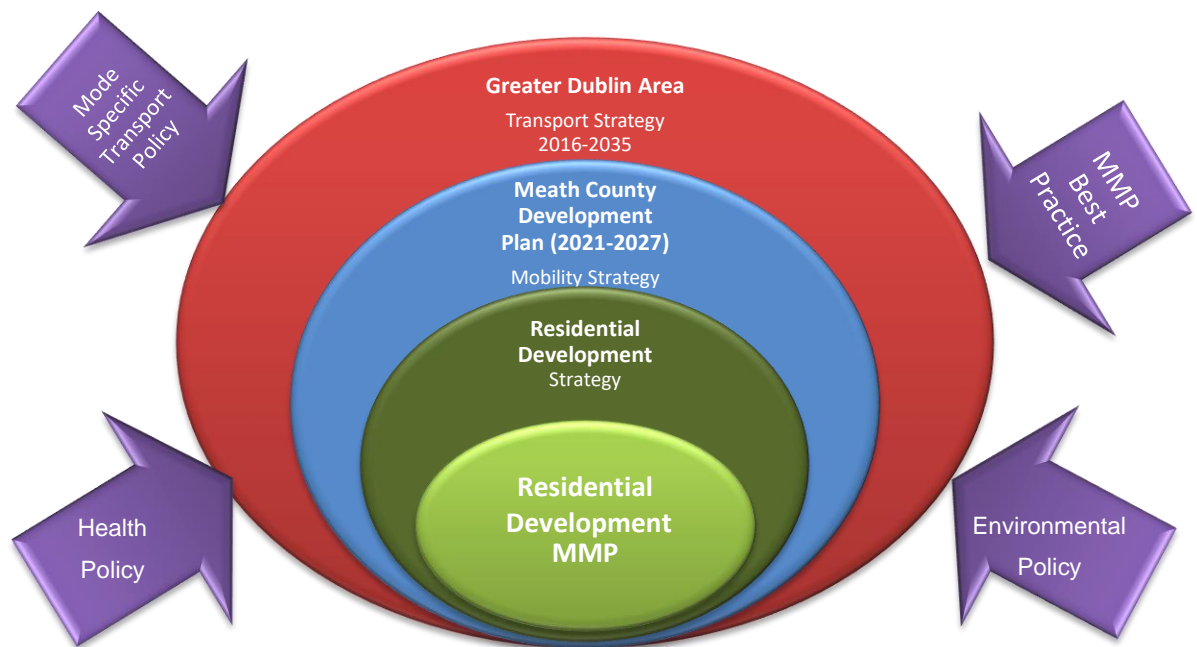
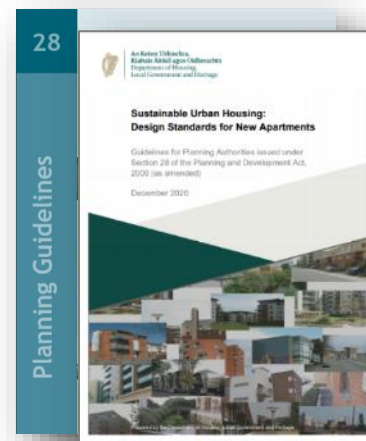

Figure 2.3: MMP Policy Framework and External Influences

Sustainable Urban Housing: Design Standards for New Apartments – December 2020

2.7.2 This guideline document was produced by the Department of Housing, Planning and Local Government and was recently updated in December 2020. The purpose of this document is to set out standards for apartment development, mainly in response to circumstances that had arisen whereby some local authority standards were at odds with national guidance.



2.7.3 With the demand for housing increasing, this means that there is a need for an absolute minimum of 275,000 new homes in Ireland's cities by 2040. It is therefore critical to ensure that apartment living is an increasingly attractive and desirable housing option for a range of household types and tenures.

2.7.4 These Guidelines apply to all housing developments that include apartments that may be made available for sale, whether for owner occupation or for individual lease. They also apply to housing developments that include apartments that are built specifically for rental purposes, whether as 'Build To Rent' or as 'shared accommodation'.

2.7.5 Cycling provides a flexible, efficient and attractive transport option for urban living and these guidelines require that this transport mode is fully integrated into the design and operation of all new apartment development schemes.

2.7.6 The quantum of car parking or the requirement for any such provision for apartment developments will vary, having regard to the types of location in cities and towns that may be suitable for apartment development, broadly based on proximity and accessibility criteria.

Smarter Travel – A Sustainable Transport Future

2.7.7 'Smarter Travel - A Sustainable Transport Future', was published in February 2009, and represents a new transport policy for Ireland for the period 2009-2020. The policy recognises the vital importance of continued investment in transport to ensure an efficient economy and continued social development, but it also sets out the necessary steps to ensure that people choose more sustainable transport modes such as walking, cycling and public transport.

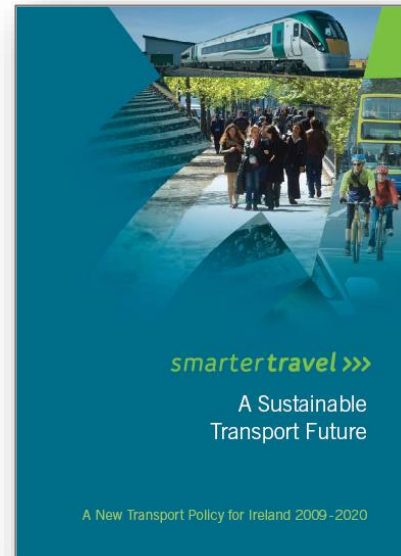

2.7.8 The policy is a direct response to the fact that continued growth in demand for road transport is not sustainable due to the resulting adverse impacts of increasing congestion levels, local air pollution, contribution to global warming, and the additional negative impacts to health through promoting increasingly sedentary lifestyles.

2.7.9 The following five key goals form the basis of the Smarter Travel policy document:

- Improve quality of life and accessibility to transport for all and, in particular, for people with reduced mobility and those who may experience isolation due to lack of transport.
- Improve economic competitiveness through maximising the efficiency of the transport system and alleviating congestion and infrastructural bottlenecks.
- Minimise the negative impacts of transport on the local and global environment through reducing localised air pollutants and greenhouse gas emissions.
- Reduce overall travel demand and commuting distances travelled by the private car.
- Improve security of energy supply by reducing dependency on imported fossil fuels.

2.7.10 These aims will be achieved through 49 specific actions, which can be broadly grouped into 4 key areas:

- Actions to reduce distance travelled by private car and encourage smarter travel,
- Actions aimed at ensuring that alternatives to the private car are more widely available,
- Actions aimed at improving the fuel efficiency of motorised transport through improved fleet structure, energy efficient driving and alternative technologies, and
- Actions aimed at strengthening institutional arrangements.

2.7.11 The opportunities and potential benefits that could be achieved by the implementation of a MMP are considered under the policy goal of encouraging Smarter Travel.

2.7.12 The Smarter Travel policy also includes for a comprehensive range of supporting 'actions' including mode specific (e.g. walking, cycling and public transport etc.) and behaviour change initiatives which both encourage and provide for sustainable travel practices for all journeys.

Design Manual for Urban Roads and Streets (DMURS) - 2019

2.7.13 DMURS guidance document was produced by the Department of Transport, Tourism and Sports and the Department of Environment, Community and Local Government in March 2013 and updated in May 2019. It provides guidance relating to the design of urban roads and streets. It presents a series of principles, approaches and standards that are necessary to achieve balanced, best practice design outcomes with regard to street networks and individual streets.

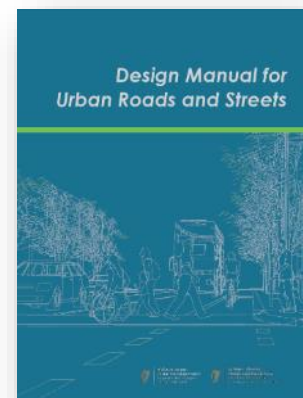

2.7.14 The manual places a significant emphasis on car dominance in Ireland and the implications this has had regarding the pedestrian and cycle environment. The document encourages more sustainable travel patterns and safer streets by proposing a hierarchy for user priorities. This hierarchy places pedestrians at the top, indicating that walking is the most sustainable form of transport and that by

prioritizing pedestrians first, the number of short car journeys can be reduced, and public transport made more accessible.

2.7.15 Second in the hierarchy are cyclists with public transport third in the hierarchy and private motor vehicles at the bottom. By placing private vehicles at the bottom of the hierarchy, the document indicates that there should be a balance on street networks and cars should no longer take priority over the needs of other users.

2.7.16 The manual emphasizes that narrow carriageways are one of the most effective design measures that calm traffic. Standard width of an arterial and link street is 3.25m, however, this may be reduced to 3m where lower design speeds are being applied. Desirable footpath widths are between 2m – 4m. The 2m width should be implemented to allow for low to moderate pedestrian activity. A 3m – 4m footpath should be implemented to allow for moderate to high pedestrian activity.

2.7.17 The focus of the manual is to create a place – based sustainable street network that balances the pedestrian and vehicle movements. The manual references the different types of street networks, including arterial streets, link streets, local streets, and highlights the importance of movement.

Transport Strategy for the Greater Dublin Area

2.7.18 Published in 2016 the role of the strategic transportation strategy (2016 to 2035) is to establish appropriate policies and transport measures that will support the Greater Dublin Area in meeting its potential as a competitive, sustainable city region with a good quality of life for all. The strategy seeks to meet:

- Economic objectives by reducing delays and improving journey time reliability; Social objectives by improving safety, reducing travel related stress and reducing the adverse impacts of traffic on neighbourhoods; and
- Environmental objectives by giving priority to those means of travel that are less damaging to our natural and built environments.



2.7.19 The strategy acknowledges that there will be only limited enhancements to road capacity, accordingly some measure of travel demand management (TDM) will be required in the form of (a) Control measures (b) Fiscal measures and (c) Other Complementary measures. One of the most important initiatives that are classified under the theme of Other Complementary measures are Mobility Management Plans.

Draft Transport Strategy for the Greater Dublin Area 2022-2042

2.7.20 The Draft Greater Dublin Area Transport Strategy 2022-2028 has arisen from a review of the original 2016 strategy. The updated document *"sets out the framework for investment in transport infrastructure and services over the next two years"*.



2.7.21 The overall aim of the Transport Strategy is *"To provide a sustainable, accessible and effective transport system for the Greater Dublin Area which meets the region's climate change requirements, serves the needs of urban and rural communities, and supports economic growth"*.

2.7.22 Four primary objectives have been identified as part of the Draft Greater Dublin Area Transport Strategy 2022-2028. These are:

- **An Enhanced Natural and Built Environment** - To Create a better environment and meet our environmental obligations by transitioning to a clean, low emission transport system, reducing car dependency, and increasing walking, cycling and public transport use.
- **Connected Communities and a Better Quality of Life** – To enhance the health and quality of life of our society by improving connectivity between people and places, delivering safe and integrated transport options, and increasing opportunities for walking and cycling.
- **A Strong Sustainable Economy** – To support economic activity and growth by improving the opportunity for people to travel for work or business where and when they need to, and facilitating the efficient movement of goods.

- **An Inclusive Transport System** – To deliver a high quality, equitable and accessible transport system, which caters for the needs of all members of society.

2.7.23 The current draft of the Transport Strategy is currently out for public consultation until 17th December 2021.

Greater Dublin Area (GDA) Cycle Network Plan (2013)

2.7.24 Based upon the National Cycle Policy Framework (NCPF), the GDA Cycle Network Plan outlines the present situation of the existing cycle route network and its relatively low usage in parts. In Fingal, the report documents how the cycling provision within the country is poor, with limited cycling facilities in urban and rural areas.

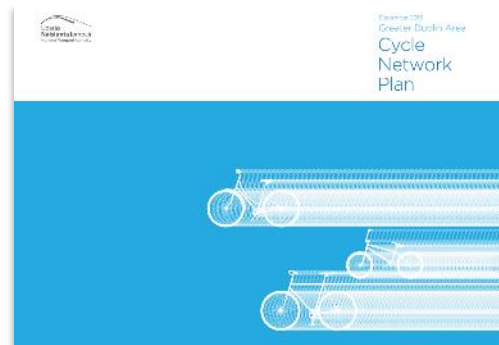

2.7.25 As part of a planned 2,340km expansion of cycle routes in the GDA, some of the proposed routes in Ashbourne include:

- **Primary Route AS1** follows Dublin Rd/Frederick St R135 Regional Road through Ashbourne.
- **Primary Route AS2** is the Ballybin Loop on west side of Ashbourne to business park.
- **Inter-urban Route M15** goes from Dunshaughlin to Ashbourne via Ratoath along quiet back roads, avoiding the busy R125.
- **Inter-urban Route M17** is the Ashbourne to Dublin route along the R125 (old N2) on hard shoulders.

2.7.26 These proposals are further described in **Chapter 2**.

Draft Greater Dublin Area Cycle Network Plan (2021)

- 2.7.27 The Draft Greater Dublin Area Cycle Network Plan 2021 has arisen as an update to the original 2013 plan, with input from local authorities within the GDA.
- 2.7.28 While the original 2013 GDA Cycle Network Plan focuses on identifying the routes required to provide an adequate network for cyclists, the updated 2021 plan seeks to enhance and strengthen local accessibility and permeability.
- 2.7.29 The proposals from the plan relating to the subject site are shown in **Chapter 2**.



Meath County Development Plan 2021 – 2027

- 2.7.30 The Meath County Development Plan 2021-2027 sets out the policies for sustainable development within the council area up to 2027.



- 2.7.31 The Meath County Development Plan 2021 – 2027 intends to promote and facilitate the provision of the necessary infrastructure to fully accommodate the demand for development and future population increases in an environmentally sustainable manner. The following policies are considered relevant to the proposed development.

Integration of Land Use and Transportation Planning

- 2.7.32 MOV POL 1. To support and facilitate the integration of land use with transportation infrastructure, through the development of sustainable compact settlements which are well served by public transport, in line with the guiding principles outlined in RPO 8.1 of the EMRA RSES 2019-2031.

- 2.7.33 MOV POL 2. To carry out strategic studies to identify and set out the delivery mechanisms for the necessary transport infrastructure to implement the Economic Development Strategy for County Meath.
- 2.7.34 MOV POL 3. To carry out strategic studies to identify and set out the delivery mechanisms for the necessary transport infrastructure to implement the Economic Development Strategy for County Meath.
- 2.7.35 MOV POL 4. To promote higher residential development densities in settlement centres along public transport corridors, subject to compliance with normal planning criteria.
- 2.7.36 MOV OBJ 1. To prepare and commence implementation of Local Transport Plans (LTP), in conjunction with the NTA and relevant stakeholders, for Drogheda (in conjunction with Louth County Council as part of the Joint Urban Plan), Ashbourne, Navan, Ratoath, and other settlements where Local Area Plans are undertaken, having regard to the Area Based Transport Assessment Guidance Notes (2019).
- 2.7.37 MOV OBJ 2. To seek regular engagement between Transport Infrastructure Ireland (TII) and the relevant Municipal District regarding road safety issues communities located on Meath's national roads.

Sustainable Transport

- 2.7.38 MOV OBJ 3. To ensure that design for cycle infrastructure for all relevant developments shall be carried out in accordance with the Greater Dublin Area Cycle Network Plan, other relevant design standards or any successors to these documents.

Cycling & Walking

- 2.7.39 MOV POL 5. To promote higher residential development densities in settlement centres along public transport corridors, subject to compliance with normal planning criteria.

Bus

- 2.7.40 MOV POL 8. To cooperate with the NTA and other relevant agencies to have ongoing reviews of the network of bus routes in Meath, and to support and encourage public transport operators to provide improved bus services in, and through the County.

- 2.7.41 MOV POL 9. To ensure that the design and planning of transport infrastructure and services accords with the principles of sustainable safety, in order that the widest spectrum of needs, including pedestrians, cyclists, the ageing population and those with mobility impairments are taken into account.
- 2.7.42 MOV POL 10. To ensure that new developments in Regional Growth Centres, Key Towns, Self-Sustaining Growth Towns and Self-Sustaining Towns are laid out so as to facilitate the provision of local bus services and the provision of Park and Ride facilities as appropriate.
- 2.7.43 MOV POL 11. To facilitate in conjunction with relevant statutory agencies alternative transport modes to the private car, including enhanced delivery of public transport services along regional corridors (as defined in the NTA's Transport Strategy for the Greater Dublin Area 2016-2035); frequent local bus services linking residential areas to District Centres and Town Centres, and which also serve shopping areas, employment areas and other activity centres, and connecting to key transport interchange points.
- 2.7.44 MOV POL 12. To support the implementation of recommendations presented in the NTA's Transport Strategy for the Greater Dublin Area 2016-2035 and any subsequent reviews thereof. To ensure that design for cycle infrastructure for all relevant developments shall be carried out in accordance with the Greater Dublin Area Cycle Network Plan, other relevant design standards or any successors to these documents.
- 2.7.45 MOV OBJ 11. To provide bus priority measures on existing and planned road infrastructure, where appropriate, in collaboration with the NTA, Bus Éireann and TII (where relevant).
- 2.7.46 MOV OBJ 12. To identify deficits in bus infrastructure and develop a priority list as a basis to secure funding for improvement works, including the provision of bus shelters, bus stops and travel information at stops.
- 2.7.47 MOV OBJ 15. To work with the NTA and all transport operators to make all existing public transport services throughout the county accessible for people with disabilities, reduced mobility and older people and require that proposals for new transport infrastructure are subject to an Accessibility Audit.

Park and Ride Facilities

- 2.7.48 MOV POL 13. To promote and support the provision of Park-and-Ride facilities which improve public transport accessibility without exacerbating road congestion at appropriate locations within the County. NTA funded Park & Ride Schemes will be carried in accordance with the recommendations of the Park & Ride Development Office of the NTA.
- 2.7.49 MOV OBJ 17. To assess and determine the potential for bus-based Park and Ride facilities, in particular, close to high quality road corridors leading from settlements in the Core Area, with good bus priority to commuter destinations in the Dublin Metropolitan area.
- 2.7.50 MOV OBJ 18. To identify and develop suitable lands to provide for Park and Ride facilities at appropriate locations in the County.

Electric Vehicles (EV) Charging Points

- 2.7.51 The Climate Action Plan, 2019 acknowledges that the pricing structure for EV vehicles is a major factor in consumers decision making. However, the Plan also acknowledges the importance of 'ensuring the EV Charging network underpins public confidence.' The Council will encourage the provision of EV charging points in all developments for future proofing.

DM OBJ 94: All car parks shall include the provision of necessary wiring and ducting to be capable of accommodating future Electric Vehicle charging points, at a rate of 20% of total space numbers.

DM OBJ 95: In any car park in excess of 20 spaces where public access is available, four fully functional charging points for Electric Vehicles shall be provided in accordance with IEC 61851 Standard for Electric Vehicle Conductive Charging Systems.



CHAPTER 3

Proposed Development

3.1 RECEIVING ENVIRONMENT

3.2 PROPOSED DEVELOPMENT

3.0 PROPOSED DEVELOPMENT

3.1 RECEIVING ENVIRONMENT

3.1.1 A full description of the subject site and the local transportation environment (including the local road network, cycle and pedestrian infrastructure and public transport provision and accessibility) is included within the Traffic and Transport Assessment accompanying this Mobility Management Plan.

3.2 PROPOSED DEVELOPMENT

3.2.1 The proposed development site consists of approximately 18.3 hectares of land in which there is currently no construction. These lands are described on Meath County Development Plan (2021-2027) as "A2 – *New Residential*", which objective is "*To provide for new residential communities with ancillary community facilities, neighbourhood facilities and employment uses as considered appropriate for the status of the centre in the Settlement Hierarchy*". It includes a small area zoned "G1 – *Community Infrastructure*", which objective is "*To Provide for necessary community, social, and educational facilities*".

3.2.2 In summary, the project comprises the development of 702 no. residential units, and 7no. commercial units, with 2no. crèches, 4no. shops and 1no. GP Practice.

3.2.3 With reference to the drawings included within this planning submission; the development schedule is summarised in **Table 3.1** and **Table 3.2** below.

Unit Type		Units		
Residential	Houses	420		
	Duplex	39		
	Apartments	1 Bed Apt.	47	243
		2 Bed Apt.	169	
		3 Bed Apt.	27	
Total		695		

Table 3.1: Development Schedule Residential use summary

Unit Type		Units	GFA
Non-Residential	Creche	2	288.56
			383.68
	Retail	4	105.58
			173.83
			190.60
			468.92
	GP Surgery	1	185.95
Total		7	1797.12

Table 3.2: Development Schedule Non-Residential use summary

- 3.2.4 Further details of the development proposals including the site layout (**Figure 3.1**) and site access arrangements are illustrated in the architects' scheme drawings as submitted with this planning application.
- 3.2.5 Taking into consideration Table 11.2 of the current Meath County Development Plan 2021-2027; and Chapter 4 of Sustainable Urban Housing: Design Standards For New Apartments Guidelines For Planning Authorities, it is considered appropriate a parking provision of 1,262 car parking spaces for the development.
- 3.2.6 In terms of the 420 no. houses, a total of 840 no. car park spaces are proposed in curtilage or on street in close proximity to the individual dwellings. This is in accordance with the MCC Development Plan.
- 3.2.7 In terms of the Apartments/Duplexes, a total of 383 no. spaces are proposed, comprising 282 no. resident and 101 visitor spaces. The residential car parking is provided at a ratio of 1.36 spaces per apartment unit (1 space for residents, 0.36 spaces for visitors), a reduced quantum from the MCC requirements of 2 spaces per unit. This reduced provision is in accordance with the DHPLG requirement, *"one car parking space per unit, together with an element of visitor parking, such as one space for every 3-4 apartments, should generally be required"*.
- 3.2.8 Block A and Block B1 will benefit from undercroft spaces, whilst Block A1 will be the only one to have a basement. The rest of spaces will be in surface.
- 3.2.9 The subject site layout and the undercroft and basement layouts are shown in below.

Block A1

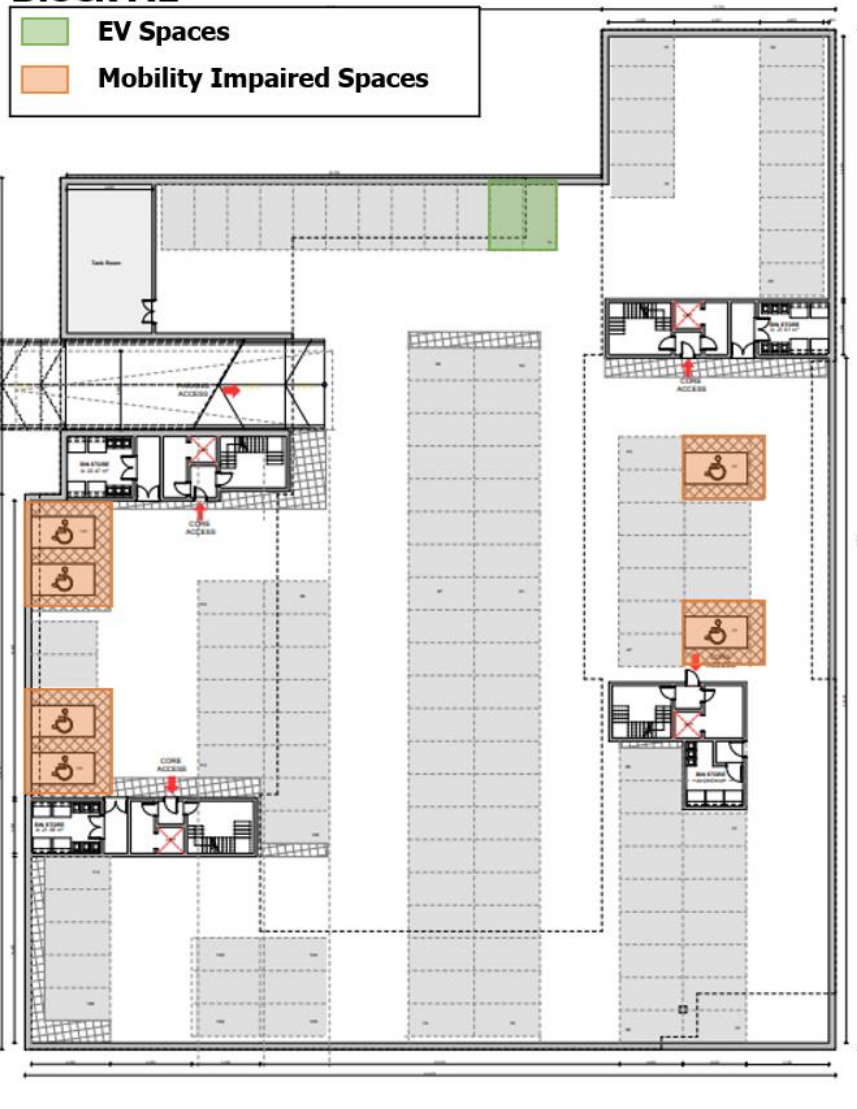

Figure 3.3: Car parking in Block A1 Basement

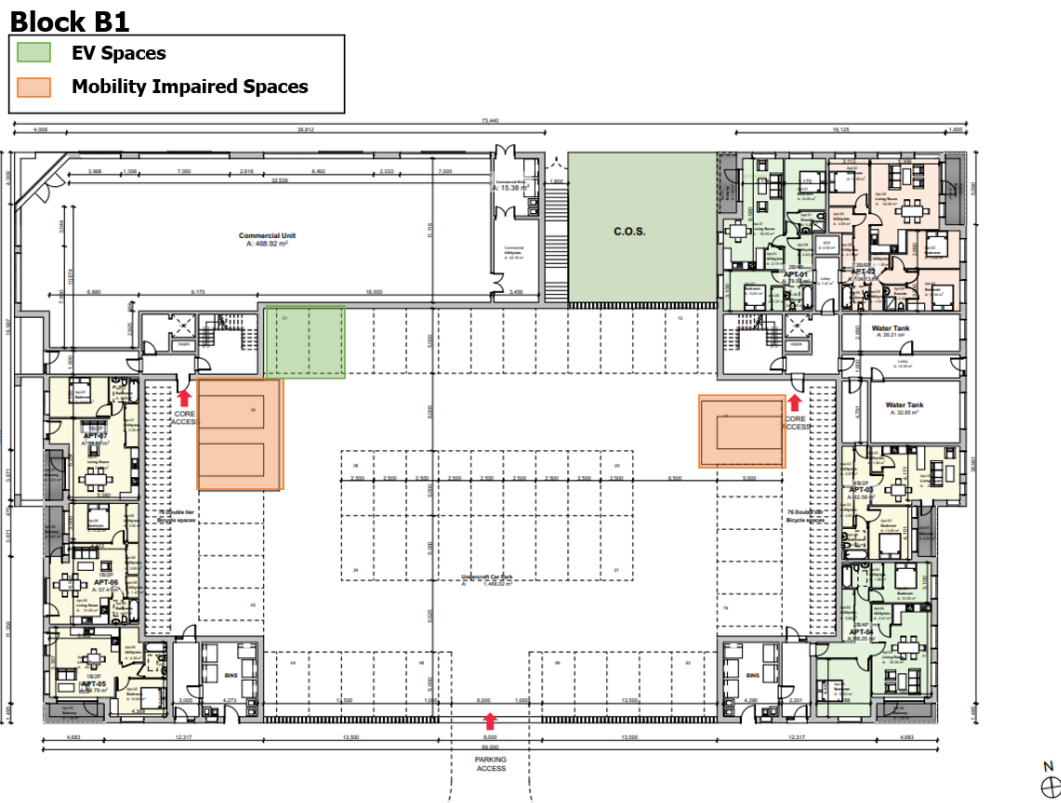

Figure 3.4: Car parking in Block B1 Basement

- 3.2.10 The development provides 869 no. bicycle parking spaces on site. 817 no. spaces of the total quantum are dedicated to residents and visitors of the apartment and duplex units, exceeding MCC requirement (776 no.), and Apartment Guidelines standard (704 no.). The non-residential uses will benefit from 52 no. spaces, higher than MCC requirement (25 no.).
- 3.2.11 A full description of the proposed development characteristics is included within the Traffic and Transport Assessment Report accompanying this Mobility Management Plan.



CHAPTER 4

Commuter Trends & Transport Needs

- 4.1 INTRODUCTION**
- 4.2 GREATER DUBLIN AREA
CONTEXT**
- 4.3 LOCAL STUDY AREA
CONTEXT**

4.0 COMMUTER TRENDS & TRANSPORT NEEDS

4.1 INTRODUCTION

- 4.1.1 It is important to establish baseline trends and area specific transport needs in developing an MMP. The site is located within an area comprising of primarily residential houses with the neighbourhood centre facilities being in close proximity. It is necessary to predict the nature of the proposed traffic to / from the site and investigate whether it is possible to influence the modal split of the commuters from the proposed development.
- 4.1.2 Varying demographic profiles that have an immediate impact on the traffic network are commuters commuting to / from home as well as other journeys such as school pick up / drop off and shopping trips. These can have their trip patterns influenced. Visitors are more difficult to influence in their trip patterns as they can be unpredictable.

4.2 GREATER DUBLIN AREA CONTEXT

- 4.2.1 The modal split for the proposed development would be compared against the modal split for the Greater Dublin Area. The Greater Dublin Area is described in **Figure 4.1**.

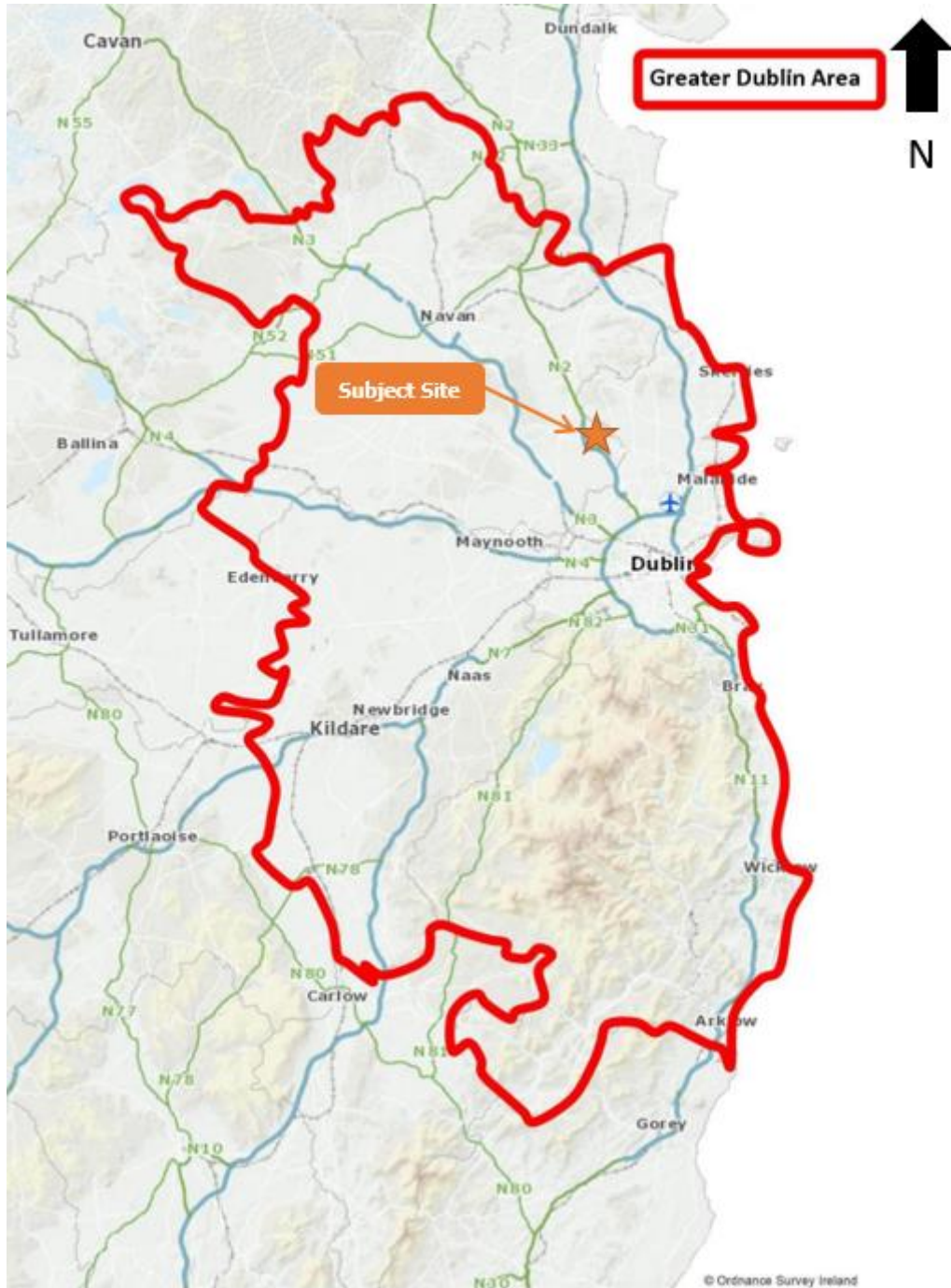

Table 4.1: Greater Dublin Area Boundary

4.2.2 The current modal split for the Greater Dublin Area is indicated in **Figure 4.2** below.

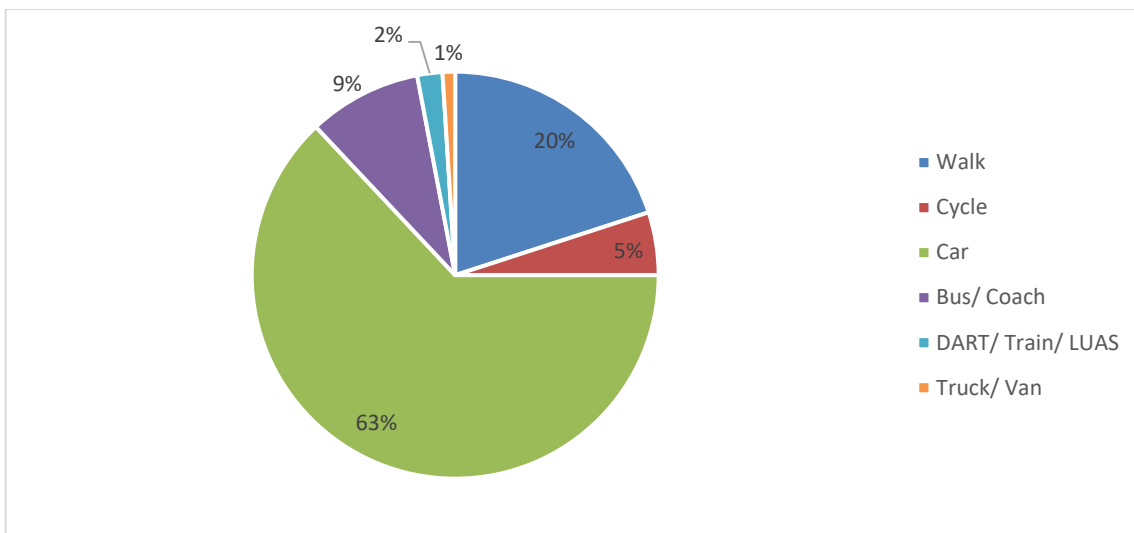

Figure 4.2: Current Modal Split in Greater Dublin Area (Source: National Household Travel Survey 2017)

4.2.3 The above modal split data has been investigated further with **Table 4.1** below summarising the modal split based on the types of trips undertaken (i.e. shopping, leisure, work, education etc.) by purpose of trip:

	Work/business	Education	Shopping	Social	Return home	Personal	Other
Truck/Van	2%	0%	0%	0%	1%	0%	0%
DART/ Train/ LUAS	3%	0%	1%	2%	2%	1%	2%
Bus/ Coach	12%	10%	7%	7%	9%	5%	4%
Car	65%	62%	65%	64%	65%	44%	82%
Cycle	7%	4%	1%	5%	5%	3%	4%
Walk	11%	23%	24%	22%	20%	48%	7%

Table 4.1: Purpose of Trip based on Modal Split in Greater Dublin Area (Source: National Household Travel Survey 2017)

4.3 LOCAL STUDY AREA CONTEXT

4.3.1 The Central Statistics Office’s SAPMAP (Small Areas Population Map) data has also been investigated to determine the travel trends within the local vicinity of the subject site on Cherry Lane, Ashbourne. SAPMAP is an interactive mapping tool that allows users to pinpoint a location on the map and access 2016 census data related to that area.

4.3.2 **Figure 4.3** below illustrates the 9no. small areas, composed of residential developments in the vicinity of the subject site. The CSO SAPMAP means of travel statistics from these sites will be used to predict modal split targets for the proposed

residential development. These sites best represent the development's future travel trends prior to the positive influence of the MMP initiatives due to its similar characteristics with the Proposed Development.

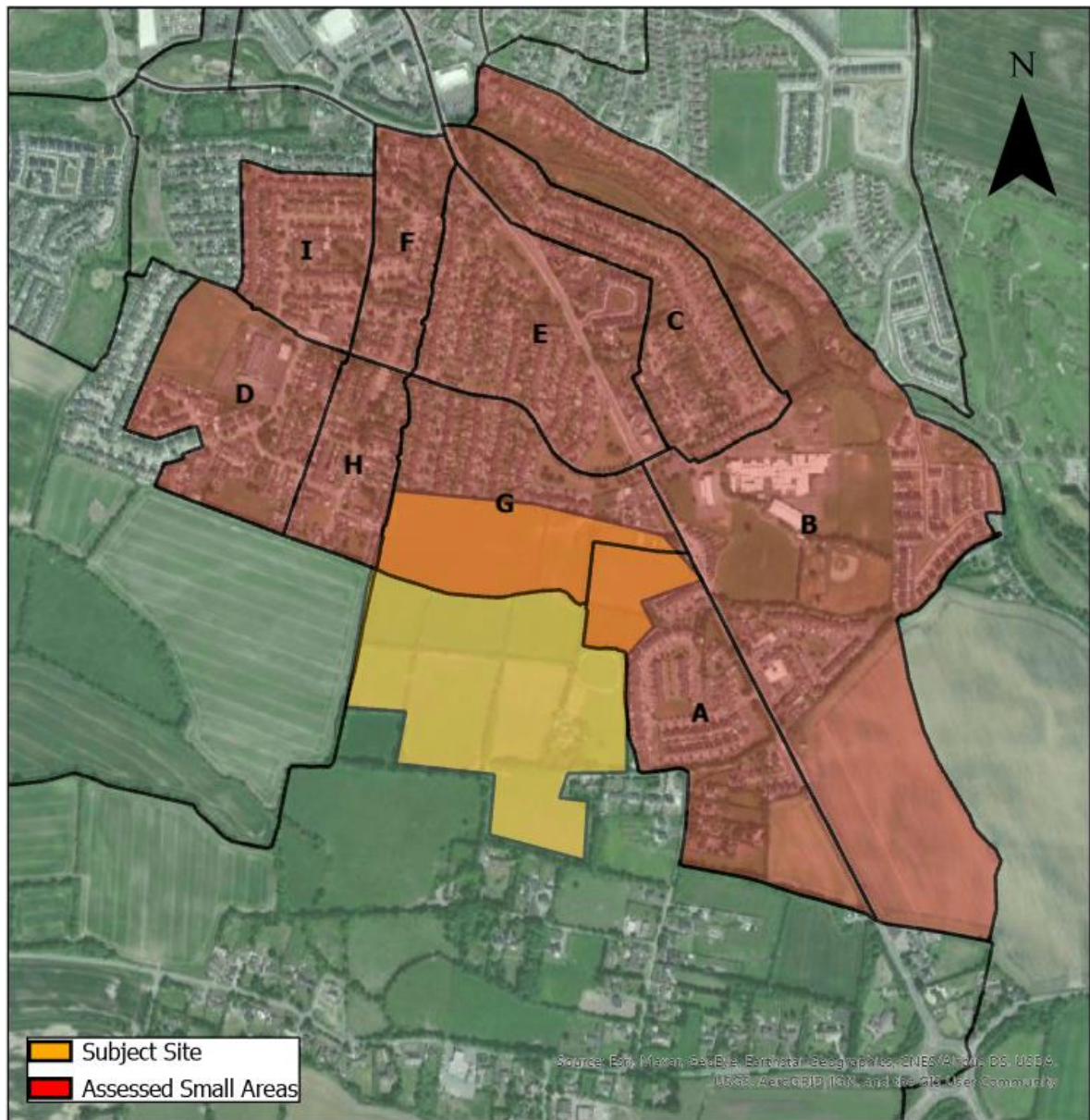

Figure 4.3: Locations of Census Small Areas Reviewed (Source: CSO)

Modal Split

4.3.3 The 2016 Census data for the modes of travel used within the Small Areas was assessed; the locations of these small areas relative to the proposed development are shown in **Figure 4.3** above. **Table 4.1** and **Figure 4.4** below depicts the modal split within the area.

Small Area no.	On foot	Bicycle	Bus, minibus or coach	Train, DART or LUAS	Motorcycle or scooter	Car driver	Car passenger	Van
A	19%	2%	6%	0%	1%	51%	18%	3%
B	15%	2%	12%	0%	2%	52%	12%	5%
C	22%	2%	19%	0%	0%	45%	7%	5%
D	23%	1%	16%	0%	3%	43%	11%	3%
E	32%	1%	14%	0%	1%	40%	9%	2%
F	24%	2%	12%	0%	1%	40%	17%	4%
G	32%	1%	18%	0%	0%	39%	7%	3%
H	27%	2%	13%	0%	1%	48%	5%	5%
I	23%	3%	11%	0%	0%	50%	9%	3%
Average	24%	2%	13%	0%	1%	45%	11%	3%

Table 4.2: Modal split of small areas assessed (Source: Census 2016)

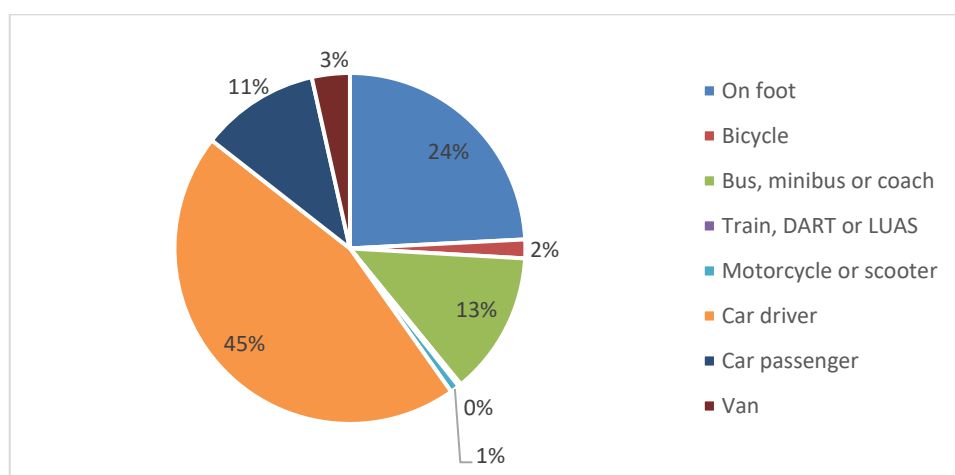

Figure 4.4: Modal Split in the subject site area (Source: CSO)

- 4.3.4 The assessment reveals that travel by car is the predominant mode of transport with 46% driving a private vehicle and 12% travelling as car passengers. Walking is the second most prominent mode of transport with a modal share of 22%. All Public transport journeys are made by bus, which suppose 13%. Bicycle trips are only 2% of total trips.
- 4.3.5 The existing modal split for the Census Small Areas reviewed shows a similar pattern with the Greater Dublin Area modal split. A lower user of the car can be seen, with 58% in the subject site area towards 63% in the GDA. Moreover, the number of trips by bus are higher, with 13% in the subject area towards 9% in the GDA, and cycling is slightly lower, with 2% in the subject site area towards 5% in the GDA. In summary, the subject site is ideally located to reduce demand for private vehicle use and encouraging the use of more sustainable transport modes, in particular cycling due to the proposed R135 cycle scheme.



5.1 INTRODUCTION

5.2 MMP OBJECTIVES

5.3 MMP ACTIONS & TARGETS

5.0 OBJECTIVES & TARGETS

5.1 INTRODUCTION

5.1.1 In order to measure the ongoing success of the Mobility Management Plan and its various measures it is important that a series of objectives are set in conjunction to a range of associated targets. The proposed objectives and targets are set out in this section of the MMP.

5.2 MMP OBJECTIVES

5.2.1 The overall aim of this MMP is to reduce the dependency on the use of the private car by increasing residents' awareness to the other travel alternatives available.

5.2.2 To support this principal objective, several sub-objectives have been set out:

- (a) Reduce private car use by encouraging people to walk, cycle, use public transport, car club share or even reduce the number of trips undertaken / required;
- (b) Make all residents aware of the sustainable transport options available to them;
- (c) Encourage the use of sustainable modes of transport;
- (d) Encourage the most efficient use of cars and other vehicles;
- (e) Reduce any transport impacts of the development on the local community;
- (f) Promote walking and cycling as a health benefit to residents;
- (g) Managing the ongoing development and delivery of the Mobility Management Plan with future residents;
- (h) Promoting smarter working and living practices that reduce the need to travel overall; and
- (i) Promote healthy lifestyles and sustainable, vibrant local communities.

5.2.3 The above objectives can be achieved through the integrated provision of hard and soft initiatives. Soft measures include the dissemination of important information regarding:

- Routing, timetable and ticketing information for bus services;

- The location and most convenient routes to / from local services (e.g. shops, medical facilities and schools etc.);
- Safe routes to school literature;
- Provision of live information for bus services at the reception;
- Provision of a free telephone service for calling a taxi, and information regarding taxi ordering apps;
- Cost data comparing public transport and private car journeys; and,
- The health benefits of walking and cycling to include safety advice.

5.2.4 While 'harder' measures include:

- Car Parking Provision and Management Strategy
- Car Pooling

5.2.5 Without such information, some people may choose the perceived option available to them which is often perceived to be the car, even if from a cost and duration of journey perspective this may not be the case.

5.2.6 Similarly, if a resident is unaware of the availability of local shops and services, they may choose to travel a greater distance than necessary in order to access a service.

5.2.7 Accordingly, the objectives of this MMP can therefore be summarised as follows:

- Consider the needs of residents in relation to accessing facilities for education, health, leisure, recreation and shopping purposes, including identifying local amenities available that reduce the need to travel longer distances; and
- Develop good urban design by ensuring permeability of the development to neighbouring areas and provision of cycle facilities including storage.

5.3 MMP ACTIONS & TARGETS

5.3.1 Targets are important as they give the MMP direction from its inception, providing measurable goals. When setting site-specific targets, it is important that they are 'SMART' (Specific, Measurable, Achievable, Realistic and Time-bound) in order that the outcome can be quantified and an assessment of what the MMP has or will achieve can be made.

5.3.2 Since the overall aim of the MMP is to minimise reliance upon the private car, it is appropriate to set a target which relates to this objective. It is also necessary to

collect data to identify and understand the baseline travel habits, against which the MMP's progress can be measured. It is recommended that residents' questionnaires are circulated once the site reaches 90% occupancy. These questionnaires will establish the baseline travel data for the subject site.

5.3.3 The Mobility Management Plan's initial actions (**A**) are set out below:

A1 – The appointment of a Mobility Manager prior to occupation of the site;

A2 – Provision of a portal to the MMP on a website for the development that includes information on all travel opportunities from the site that is made available to all residents prior to site occupation;

A3 – In consultation with key stakeholders including the local authority, continually develop, implement, monitor, evaluate and review the progress of the MMP towards achieving the targets;

A4 – To undertake a baseline travel survey when 90% of the residential units are occupied;

A5 – To update modal split targets which can be reviewed once the baseline travel characteristics are established.

5.3.4 The Mobility Management Plan's principal targets (**T**) are set out below:

T1 – To support the development of the Cherry Lane lands as a sustainable community;

T2 – To provide sustainability in all ways including cost, health and environment – reducing the impact on traffic congestion and air quality;

T3 – To achieve a 95% resident awareness of the MMP and its aims and objectives;

T4 – To facilitate and encourage greater use of sustainable transport modes (walking, cycling, public transport) in preference to the use of the private car;

T5 – Achieve the identified modal split travel targets.

5.3.5 The above targets will be achieved by introducing an integrated package of measures that focus on promoting travel to and from the subject development by sustainable modes of transport as a viable alternative to the private car. These means and supporting strategies will seek to encourage residents and visitors to consider lower carbon travel alternatives in everyday journeys. The MMP would

subsequently seek to transfer this previous 'car' based trips onto the following modes / travel options:

- Bus
- Cycle
- Car Sharing

5.3.6 The interim mode split targets for the subject site are set out in **Table 5.1**.

Mode of Travel	Census 2016	1 st Year Target (2023)	MMP 5 - year Target (2028)
On foot	22%	22%	22%
Bicycle	2%	4%	7%
Bus, minibus or coach	13%	14%	15%
Train, DART or LUAS	0%	0%	0%
Motorcycle or scooter	1%	1%	1%
Car driver	46%	44%	41%
Car passenger	12%	11%	10%
Van	4%	4%	4%

Table 5.1: Mode Share Targets for Proposed Development

5.3.7 The above targets are intended to be both realistic and aspirational as to act as a motivation for the MMP in general whilst remaining attainable. These targets are subject to ongoing revision following the completion of the baseline surveys (and subsequent surveys) once the site is occupied and the input of the MMP's key stakeholders.

5.3.8 The data shown previously in **Chapter 4**, has been considered to determine the most likely travel trends for this development and thus generated an accurate prediction for modal splits, shown in **Table 5.1** above, and predicted trips from existing census data; this information displays the existing sustainable baseline. These goals have been set with an overall goal of delivering a sustainable development, and with the vision of setting attainable yet ambitious targets to ensure measurable success for this mobility management plan.



- 6.1 INTRODUCTION**
- 6.2 MODE SPECIFIC MEASURES**
- 6.3 MANAGEMENT &
MONITORING MEASURES**
- 6.4 MARKETING & PROMOTION
MEASURES**

6.0 MMP MEASURES

6.1 INTRODUCTION

6.1.1 Mobility management plans have a wide range of possible “hard” and “soft” tools from which to choose from with the objective of influencing travel choices. The following section introduces potential strategy measures that could be considered at the subject residential development. The range of initiatives discussed here is by no means exhaustive, but is indicative of the kind of measures available and the processes and resources required to implement them.

6.1.2 The 5 tier Travel Plan Pyramid below has been developed to illustrate the key elements of a successful Mobility Management Plan. (Reference: *Good Practice Guidelines: Delivering Travel Plans through the Planning System*, DfT (UK), 2009)

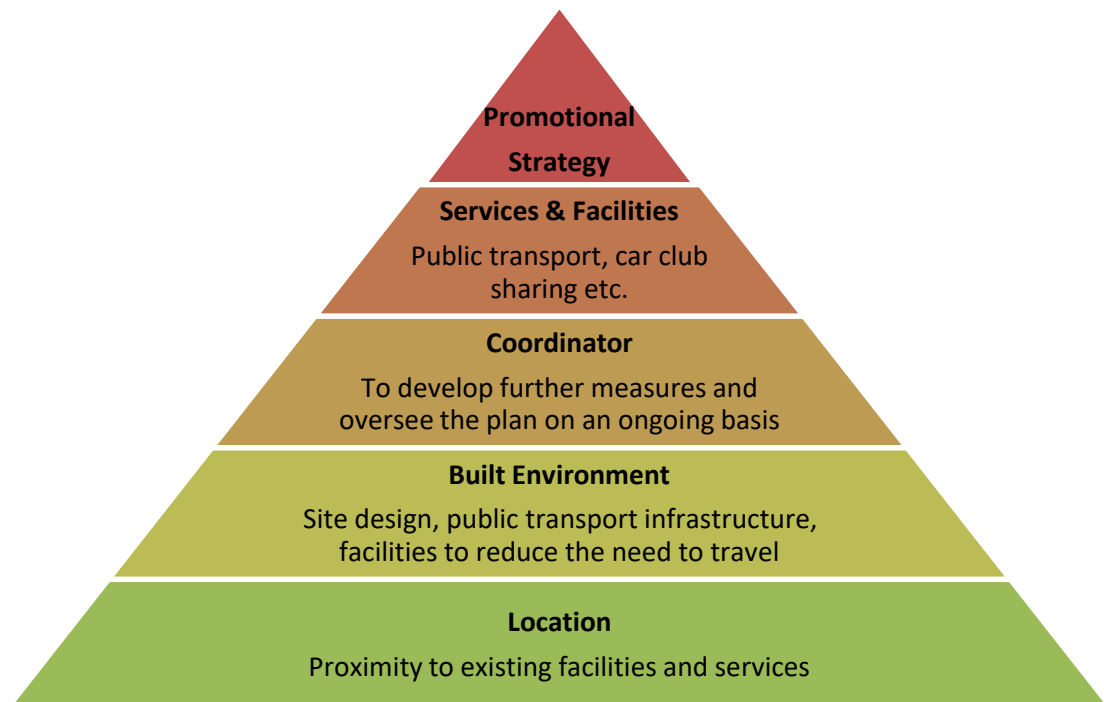

6.1.3 Accordingly, the Residential MMP is organised as a series of integrated sub-strategies covering the different modes of travel and associated management and awareness related issues to all modes.

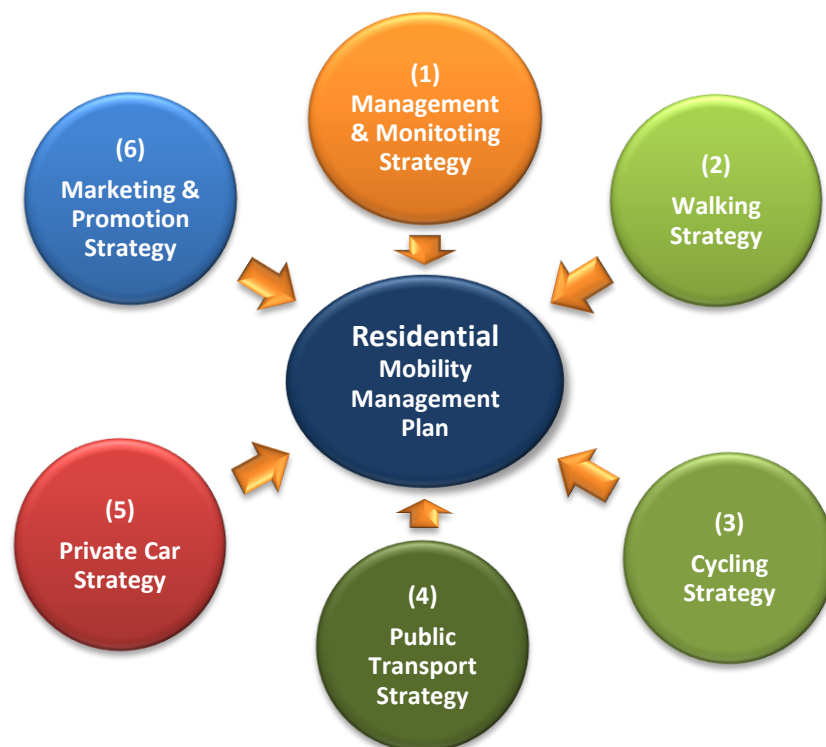

Figure 6.1: MMP Action Plan Strategies

6.2 MODE SPECIFIC MEASURES

6.2.1 The following initiatives could be promoted to enable the objectives to be fulfilled, to encourage the best choice of travel other than private car.

- a) Walking – provision of facilities
- b) Cycling – discounted cycle purchase, bike service workshops, cycle training
- c) Public Transport (Bus) – discounted travel tickets
- d) Private Car Strategy including car sharing and car clubs

6.2.2 These mode specific measures are discussed in more detail in **Appendix A** which is appended with this document.

6.3 MANAGEMENT & MONITORING MEASURES

6.3.1 Ensuring the success of a Mobility Management Plan, defining a management structure is critical to its effective implementation. Therefore, a Mobility Manager must be appointed and a Resident's Group should be established. This will ensure the ongoing success of the MMP.

- 6.3.2 A programme of monitoring has been designed to generate information by which the success of the MMP can be evaluated. This will be the responsibility of the Mobility Manager.
- 6.3.3 The MMP information will be reviewed and updated regularly. This is achieved by research into the travel options and liaising with the residents to determine the most appropriate and useful information to communicate. The Mobility Manager will also be responsible for managing the annual review of the MMP including the surveys to be undertaken by the residents.
- 6.3.4 Details of these measures can be found in **Appendix B** of this document.

6.4 MARKETING & PROMOTION MEASURES

- 6.4.1 The Mobility Manager will be involved in the promotion of the MMP and to make residents aware of its existence.
- 6.4.2 The most important and cost-effective measure to be introduced as part of this MMP is the 'Welcome Travel Pack', which will be issued to all new residents of the site when they move in.
- 6.4.3 The Pack will contain information about all modes of transport available for journeys to and from the site. It includes information related to journeys to a number of local destinations which are considered to be key to residents. These include colleges, local shops, health facilities, and bus stops.
- 6.4.4 Information within the Pack will include details of the listed destinations and the services and facilities they offer. In addition, contact details of the Mobility Manager will be provided. The Pack will also give details of safe pedestrian and cycle routes from the site, fare and timetable information for public transport.
- 6.4.5 A simple cost-benefit analysis of public transport versus the use of the private car will also be set out in the Travel Pack. This, along with all of the information contained within the Pack will be available prior to occupation and will be reviewed annually and updated as necessary.
- 6.4.6 The methods of the marketing are set out in **Appendix C** of this document.



- 7.1 Overview**
- 7.2 Management & Monitoring Strategy**
- 7.3 Walking Strategy**
- 7.4 Cycling Strategy**
- 7.5 Public Transport Strategy**
- 7.6 Private Car Strategy**
- 7.7 Marketing & Promotion Strategy**

7.0 PRELIMINARY ACTION PLAN

7.1 OVERVIEW

- 7.1.1 The coordinated application of the following 6 integrated sub-strategies ensures that the success of the MMP will be a product of the sum of all sub-strategies.
- 7.1.2 The following sections consider each specific sub-strategy within which details of the proposed actions are identified for the period of this plan. The proposed timescale of each MMP initiative are categorised as Completed, Short Term (1 year), Medium Term (3 years) or Long Term (5 years).

7.2 MANAGEMENT AND MONITORING STRATEGY

MMP Management

- 7.2.1 The development, implementation and coordination of the MMP in the short, medium and long term require management support and resources if it is to be successful in achieving its long-term aspirations and targets. Funding for many of the specific actions will need to be assigned appropriate budgets. The proposed management company is fully committed to the implementation, management and monitoring of the MMP. Some of the measures may in the longer-term result in cost savings. The role of management will also actively seek a partnership approach with other organisations as part of the continued development of the MMP.

MMP Monitoring

- 7.2.2 It is essential that the continued rollout and subsequent impact of the MMP initiatives is monitored on a regular basis for the following principal reasons;
- To demonstrate that the various targets are being achieved (or not met, at which point the measures being used should be reviewed) as people only value what they can measure and relate to,
 - To ensure that the MMP continues to receive the support of the building complex's management, staff and its partners (internal and external),
 - To show that both financial and resource input is being utilised to maximum effect.

7.2.3 To ensure that the MMP is responsive to emerging opportunities and operational requirements, the status of the principal management and monitoring focused initiatives of the Residential MMP are outlined in **Table 7.1** below.

Table 7.1: Preliminary Schedule of MMP Management & Monitoring Initiatives

Ref	Initiative	Status / Timescale				Lead Party	Comments
		Completed	Short (1 year)	Medium (3 years)	Long (5 years)		
MMS 1	Appointment of a Mobility Manager	-	✓	-	-		
MMS 2	Establish MMP Steering Group and meeting / reporting arrangements	-	✓	-	-		
MMS 3	Nominate MMP 'Champion' and role (Management)	-	✓	-	-		
MMS 4	Establish MMP 'Charter' and confirm management support for;						
	MMS 4a – MMP memorandum of understanding	-	✓	-	-		
	MMS 4b – Identify and agree MMP objectives	-	✓	-	-		
	MMS 4c – Review and establish MMP targets	-	✓	✓	✓		
MMS 5	In partnership with Local Authority review funding opportunities and potential budgets for;						
	MMS 5a – Setting up and launching MMP	-	✓	-	-		
	MMS 5b – Annual MMP management costs	-	✓	-	-		
	MMS 5c – Participation in calendar of events	-	-	✓	✓		
	MMS 5d – MMP incentives	-	-	✓	✓		
	MMS 5e – MMP facilities	-	-	✓	-		
	MMS 5f – MMP training requirements	-	✓	-	-		
MMS 6	Establish 'External' engagement contacts and collaboration programme.	-	✓	-	-		
MMS 7	Agree Monitoring and Reporting Programme with respect to;						
	MMS 7a – Resident Travel Surveys	-	✓	-	✓		
	MMS 7b – Roll out / uptake of MMP initiatives	-	-	✓	✓		
	MMS 7c – MMP Budgets	-	✓	✓	✓		
	MMS 7d – MMP performance (Key Performance Indicators - KPIs)	-	✓	-	-		
MMS 8	Facilitate the establishment and operation of mode specific 'user' groups (e.g. walking, cycling etc.)	-	-	✓	-		

MMS 9	Review travel practises by trip purpose and implement policy to encourage sustainable travel practices.	-	-	-	✓		
MMS 10	Appoint a resident 'Champion' for each mode specific 'user' group (e.g. walking, cycling, public transport etc.)	-	-	-	✓		
MMS 11	A Sustainable Travel Pack to be provided to all new Residents	-	✓	✓	-		

7.2.4 The identified Management and Monitoring strategy promotes a total of 21 measures. The implementation schedules of these measures are outlined in **Graph 7.1** below.

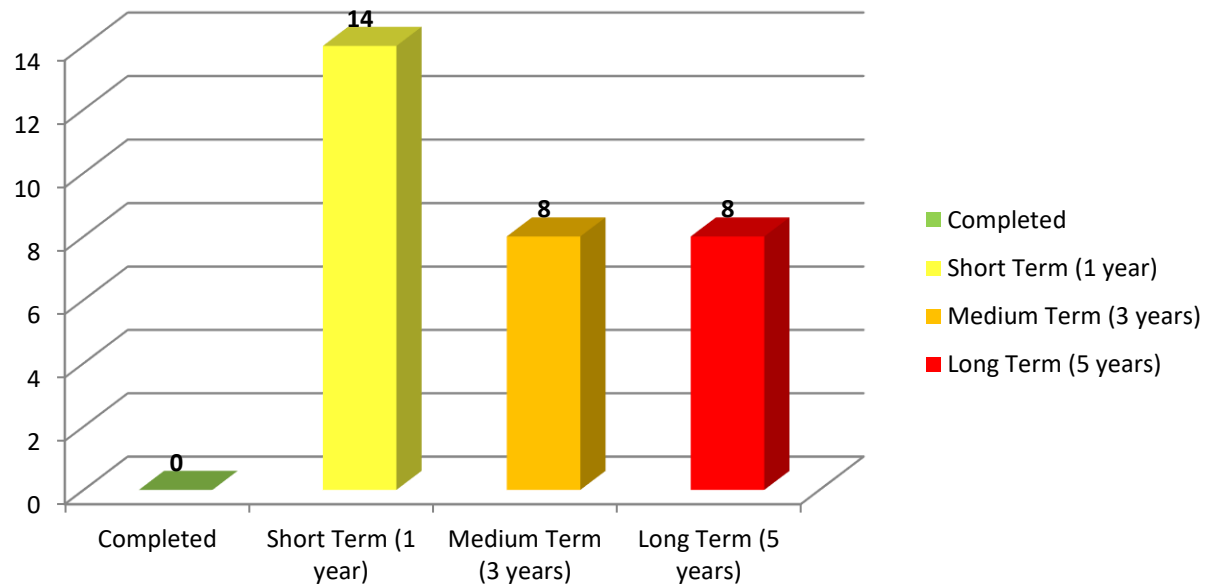

Graph 7.1: Roll-out of MMP's Management & Monitoring Initiatives

7.3 WALKING STRATEGY

7.3.1 The status and preliminary scheduling of the principal walking focused initiatives of the MMP are outlined in the **Table 7.2** below.

Table 7.2: Preliminary Schedule of MMP's Walking Initiatives

Ref	Initiative	Status / Timescale				Lead Party	Comments
		Completed	Short (1 year)	Medium (3 years)	Long (5 Years)		
WS 1	Develop a 'Walking' Accessibility Sheet for the site.	-	✓	-	-		
WS 2	Explore the opportunity of creating a calendar of 'Walking' Events and incentives:						
	WS 2a - Walk to work / school week	-	-	✓	-		
	WS 2b - Walk on Wednesdays	-	-	✓	-		
	WS 2c - Pedestrian Training	-	-	✓	-		
	WS 2d - Travel diary with incentive / awards scheme	-	-	-	✓		
WS 3	Investigate the potential benefit and uptake of setting up a 'buddying' scheme to address personal security issues of walking:						
	<ul style="list-style-type: none"> WS 3a - Commuters WS 3b - School children 	-	-	-	✓		
WS 4	Undertake route audit and implement a review program to ensure appropriate infrastructure is provided / upgraded to meet walking and accessibility requirements for External routes to key off-site destinations	-	-	-	✓		
		-	✓	-	-		
WS 5	Develop a 'Walking' Fact Sheet	-	✓	-	-		

7.3.2 The MMP’s Walking Strategy promotes a total of 10 measures. The preliminary implementation schedule of these walking initiatives is outlined in **Graph 7.2** below.

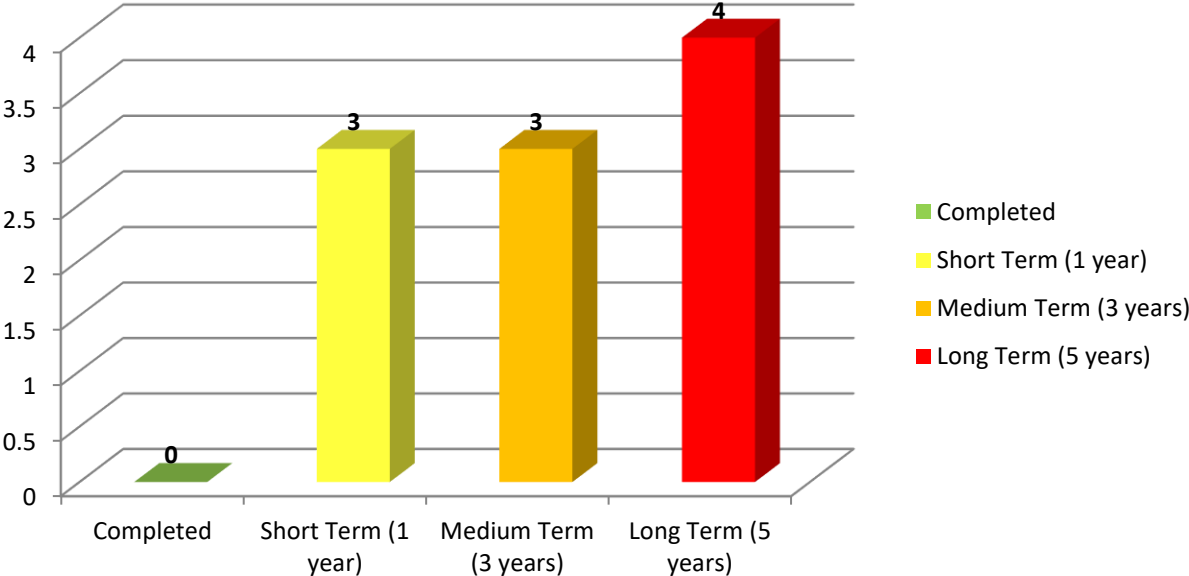

Graph 7.2: Roll-out of MMP’s Walking Initiatives

7.4 CYCLING STRATEGY

7.4.1 The status and preliminary scheduling of the principal cycling focused initiatives of the MMP are outlined in the **Table 7.3** below.

Table 7.3: Preliminary Schedule of MMP's Cycling Initiatives

Ref	Initiative	Status / Timescale				Lead Party	Comments
		Completed	Short (1 year)	Medium (3 years)	Long (5 Years)		
CS 1	Investigate the potential benefit and uptake of setting up a scheme to address personal security issues associated with cycling	-	-	✓	-		
CS 2	Explore the opportunity of establishing a Bike Users Group	-	-	-	✓		
CS 3	Develop a 'Cycling' Accessibility Sheet for the site	-	✓	-	-		
CS 4	Explore the opportunity of creating a calendar of 'Cycling' Events and incentives	-	-	✓	-		
CS 5	Undertake route audit and implement a review program to ensure appropriate infrastructure is provided / upgraded to meet cycling requirements for external routes to key off-site destinations	-	-	-	✓		
CS 6	Investigate the potential demand for providing cycle training	-	-	-	✓		
CS 7	Explore the potential for launching a Travel Diary incentive / awards scheme	-	-	-	✓		
CS 8	Examine the opportunity and potential benefits and uptake of Bike service / maintenance workshops	-	-	✓	-		
CS 9	Market / Publicise the potential availability of employer operated discounted cycle purchase incentives	-	-	✓	-		

7.4.2 The MMP's Cycling Strategy promotes a total of 9 measures. The preliminary implementation schedule of these cycling initiatives is outlined in **Graph 7.3** below.

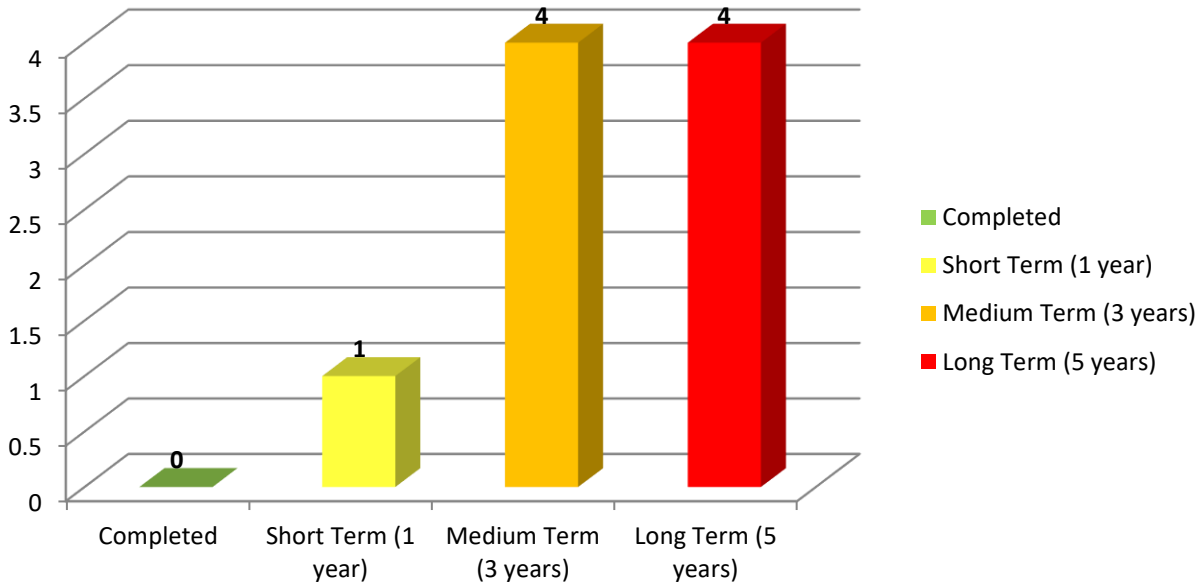

Graph 7.3: Roll-out of MMP's Cycling Initiatives

7.5 PUBLIC TRANSPORT STRATEGY

7.5.1 The status and preliminary scheduling of the principal public transport focused initiatives of the MMP are outlined in the **Table 7.4** below.

Table 7.4: Preliminary Schedule of MMP's Public Transport Initiatives

Ref	Initiative	Status / Timescale				Lead Party	Comments
		Completed	Short (1 year)	Medium (3 years)	Long (5 Years)		
PTS 1	Explore the opportunities of;	✓	-	-	-		
	PTS 1a - maintaining the existing bus services PTS 1b - Enhancing the catchment of these services	-	-	-	✓		
PTS 2	Market / Publicise the potential for residents through their employers to purchase both annual and monthly TaxSaver tickets	-	✓	-	-		
PTS 3	Investigate the potential benefits of establishing a Public Transport Users Group	-	-	-	✓		
PTS 4	Develop a 'Public Transport' Accessibility Sheet for the site	-	✓	-	-		
PTS 5	Compile and disseminate a 'Public Transport' Fact Sheet	-	✓	-	-		
PTS 6	Explore the opportunity of implementing a calendar of 'Public Transport' Events and incentives	-	-	-	✓		
PTS 7	In partnership with Bus Operators (Bus Eireann, AshbourneConnect) and local authority ensure all local bus interchanges display up to date timetables, fare and route information	-	-	✓	-		
PTS 8	Encourage the use / initiatives for buses where feasible for a range of different travel purposes	-	✓	-	-		
PTS 9	Promote the availability of the TaxSaver scheme	-	✓	-	-		
PTS 10	Explore the potential of a Travel Diary incentive / awards scheme	-	-	-	✓		

7.5.2 The identified Public Transport strategy promotes a total of 11 measures. The implementation schedule of these measures is outlined in **Graph 7.4** below.

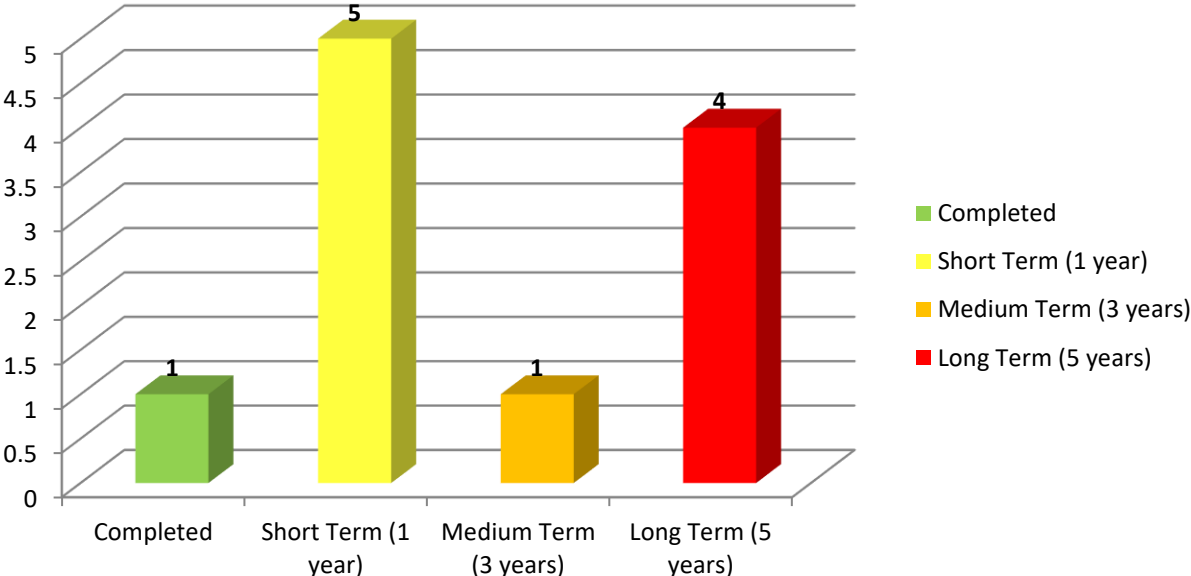

Graph 7.4: Roll-out of MMP's Public Transport Initiatives

7.6 PRIVATE CAR STRATEGY

7.6.1 The identified action plan and preliminary scheduling of the principal private car focused initiatives of the MMP are outlined in the **Table 7.5** below.

Table 7.5: Preliminary Schedule of MMP's Private Car Initiatives

Ref	Initiative	Status / Timescale				Lead Party	Comments
		Completed	Short (1 year)	Medium (3 years)	Long (5 Years)		
PCS 1	Investigate the benefits of developing a 'Car' Fact Sheet	-	✓	-	-		
PCS 2	Develop a Parking Management Strategy	✓	-	-	-		
PCS 3	Explore the opportunities of encouraging informal arrangements between residents for 'shared' travel to work practices	-	-	✓	-		
PCS 4	Encourage use of formal car sharing website (www.carsharing.ie)	-	✓	-	-		
PCS 5	Explore the opportunities of encouraging informal arrangements between residents for 'shared' travel to school/college	-	-	✓	-		
PCS 6	Determine the suitability / potential / benefits of a local Car Club scheme	-	✓	-	-		

7.6.2 The MMP’s Private Car Strategy promotes a total of 6 measures. The preliminary implementation schedule of these private car focused initiatives is outlined in **Graph 7.5** below.

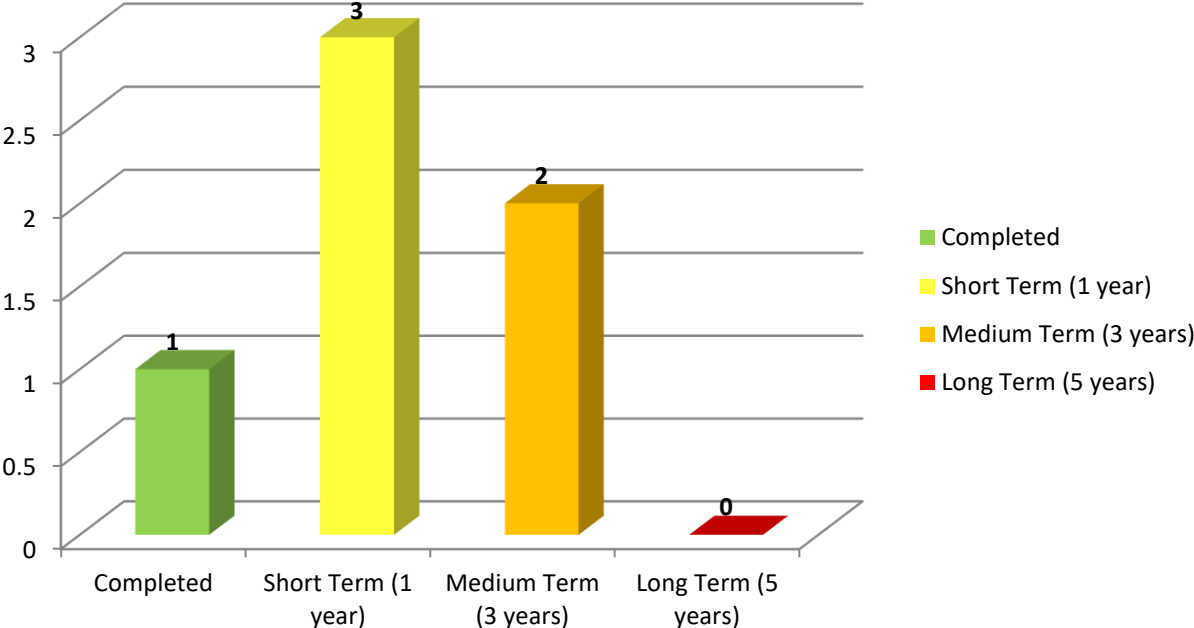

Graph 7.5: Roll-out of MMP's private Car Initiatives

7.7 MARKETING AND PROMOTION STRATEGY

7.7.1 Increasingly referenced as the 'softer' form of initiatives, the provision of detailed information, raising awareness and promotion of the MMP and its measures is imperative to its success. The strategy involves the marketing and communication of the benefits of alternative active and more sustainable travel, increasing awareness of the adverse impacts of travel and transport on the environment, health and communities (local and national), by identifying ways in which individuals can make a difference will be an important element of the MMP. The Marketing and Promotion strategy also supports a number of the other interdependent MMP sub-strategies.

Table 7.6: Preliminary Schedule of MMP's Marketing & Promotion Initiatives

Ref	Initiative	Status / Timescale				Lead Party	Comments
		Completed	Short (1 year)	Medium (3 years)	Long (5 Years)		
MPS 1	Develop a marketing plan for the MMP	-	✓	-	-		
MPS 2	Compile formal 'Sustainable Travel' induction package or 'Welcome Travel Pack' for each dwelling	-	✓	-	-		
MPS 3	Explore the cost benefits of developing a dedicated MMP website	-	✓	-	-		
MPS 4	Investigate the opportunity of developing an events calendar with 2 to 4 events per year and a supporting promotion strategy to market each event	-	-	✓	-		
MPS 5	Incorporate section / report success etc. of MMP process in local newsletters and other information dissemination initiatives	-	-	-	✓		
MPS 6	As part of Induction Sales Meeting with residents introduce the residential MMP, its objectives and recommended travel practices	-	✓	-	-		
MPS 7	Explore the cost benefits of developing a MMP App to enhance access to MMP information and events	-	✓	-	-		
MPS 8	Investigate the opportunity for a MMP annual newsletter for distribution to all residents	-	✓	-	-		

7.7.2 The preliminary Marketing and Promotion sub-strategy promotes a total of 8 measures. The implementation schedule of these measures is outlined in **Graph 7.6** below.

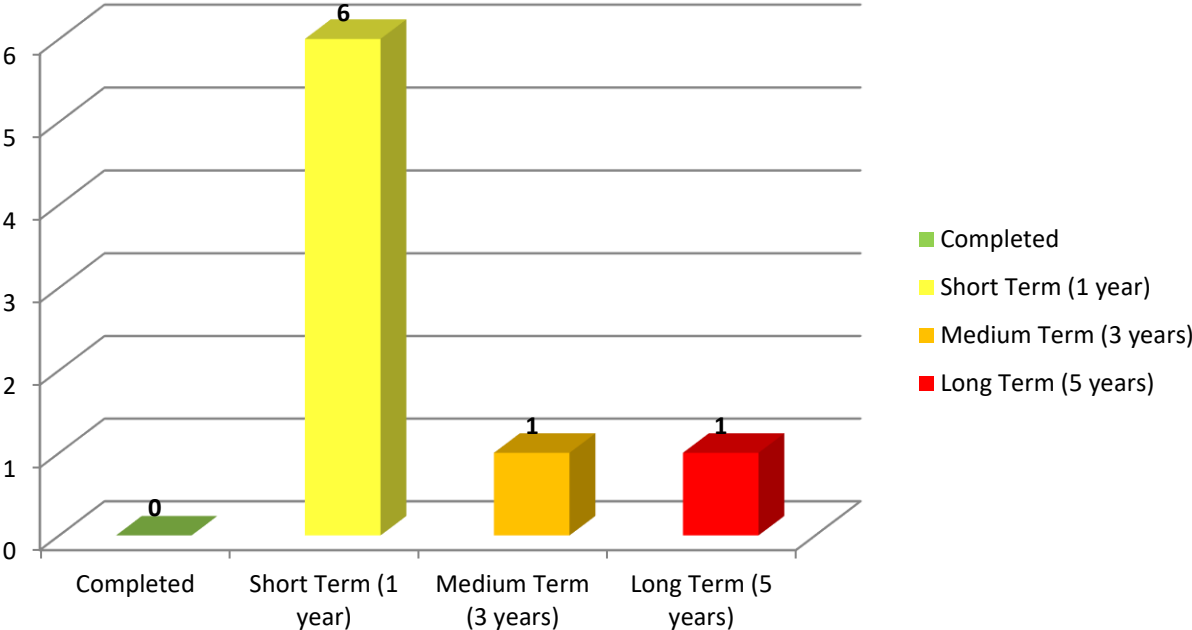

Graph 7.6: Roll-out of MMP's Marketing & Promotion Initiatives



CHAPTER 8

Summary & Conclusion

8.1 SUMMARY

8.0 SUMMARY AND CONCLUSIONS

8.1 SUMMARY

- 8.1.1 DBFL Consulting Engineers (DBFL) has been commissioned by Davey Smith Architects, on behalf of Arnub Ltd. & Aspect Homes (ADC) Ltd., to prepare a Mobility Management Plan (MMP) for a proposed residential development at Cherry Lane, Ashbourne, Co. Meath.
- 8.1.2 Arnub Ltd. & Aspect Homes (ADC) Ltd. seek permission for a strategic housing development, located in the townlands of Baltrasna and Milltown, Ashbourne, Co. Meath. The proposed development site is located to the west of the R135 Dublin Road, south of existing housing at Alderbrook Rise, Alderbrook Downs & Alderbrook Heath, east of existing housing at Tara Close & Tara Court, south of Cherry Lane and west of Hickey's Lane.
- 8.1.3 The development will consist of 702 no. dwellings, comprised of 420 no. 2 & 3 storey, 2, 3, 4 & 5 bed houses, 39 no. 2 & 3 bed duplex units in 19 no. blocks, and 243 no. 1, 2 & 3 bed apartments in 20 no. buildings, which range in height from 3, 3-4, 4-5, & 4-6 storeys. The proposed development also provides for the following uses: (i) 2 no. creches (c.288.56m² & 383.68m²) accommodated in Blocks A and A1 respectively, (ii) 4 no. retail/commercial units (c. 105.58 m² & 173.83m² in Block A, c.190.6m² in Block A1 & c.469m² in Block B1) and (iii) GP practice / medical use unit (c.186m²) in Block A1.
- 8.1.4 Access to the development will be via (i) Cherry Lane to the north-east, off the R135 Dublin Road, via a new proposed internal access road and (ii) via Hickey's Lane to the east, off the R135 Dublin Road, including pedestrian and cycle paths.
- 8.1.5 The proposed development provides for (i) all ancillary / associated site development works above and below ground, (ii) public open spaces, including hard & soft landscaping, play equipment & boundary treatments, (iii) communal open spaces, (iv) undercroft, basement & surface car parking (v) bicycle parking (vi) bin storage, (vii) public lighting, (viii) plant (M&E), utility services & ESB sub-stations, all on an overall application site area of 20.04Ha.
- 8.1.6 The proposed development also includes for an area of c. 1Ha reserved for a school site and playing pitch in the western part of the site. Permission is also sought to

demolish all existing structures on site, i.e. 3 no. single storey dwellings & associated out-buildings (659m² in total).

- 8.1.7 DBFL Consulting Engineers have compiled this MMP as the basis for discussions between the developers and planning officers from Meath County Council. Through these scoping discussions the preferred strategy (and supporting measures and targets) will emerge with the resulting MMP detailing the agreed approach, actions and targets.
- 8.1.8 The measures proposed in this document will not only benefit the residents but will also help to mitigate any potential transport impacts of the development on the wider local community.
- 8.1.9 The identified preliminary action plan promotes a total of 69 initiatives across 6 sub strategy themes as presented in the Pie Chart below.



Figure 8.1: MMP Sub Strategy Themes & Initiatives

- 8.1.10 The implementation schedule of identified 69 MMP initiatives is outlined in **Graph 8.1** below. Two of the initiatives (3%) of the action plan has been completed, with 32 initiatives (or 43%) planned to be implemented within 1 year of the residential development being occupied.

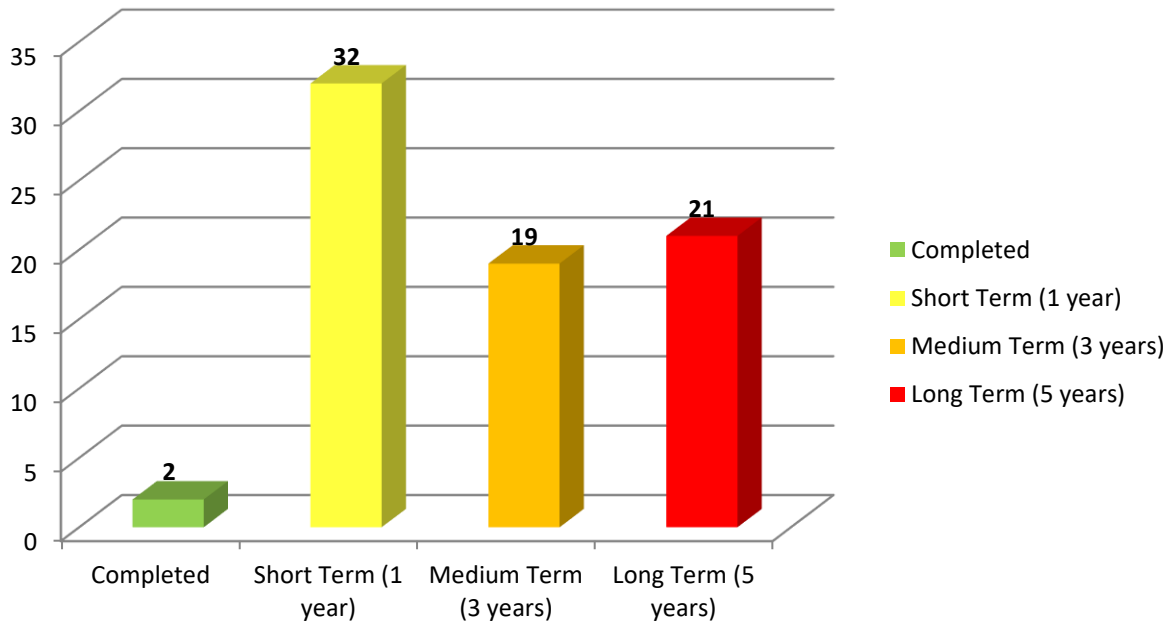

Graph 8.1: Roll-out of MMP's Initiatives

8.1.11 In the context of the subject residential development's operational framework, the local receiving environment and the identification of the Preliminary Action Plan as summarised previously, this document seeks to form the basis by which;

- the specific travel characteristics for the proposed residential development are outlined and presented to the local authority, and
- through a partnership approach between the developers and the local planning authority, the Preliminary Action Plan is explored and re-examined with the objective of reaching agreement upon the MMP's measures and subsequently the adoption of an 'agreed' MMP Action Plan with specific targets, initiatives, timescales, responsibilities and resources clearly outlined and approved by both parties.

Appendices

Appendix A

Mode Specific Measures

A1.0 MODE SPECIFIC MEASURES

Car Usage - Parking Management Strategy

A1.1 A Parking Management Strategy has been prepared by DBFL to manage the daily usage of the 407 no. car parking spaces provided as part of the development, including 371 no. for apartment and duplex units, and 36 no. for non-residential units. The parking strategy is founded on the principles that none of the residential units will be allocated a parking space as part of the rental agreement for the property.

A1.2 Aside from the GoCar, creche and taxi and set-down spaces, the remaining spaces will be available for tenants to rent on a need's basis. The cost associated with the parking spaces is expected to be in the region of €100 – 150 per month which is specified at such a rate so as to discourage the use of the private vehicle unless necessary and to encourage the uptake of more sustainable modes such as walking, cycling and public transport for which there are excellent opportunities within and directly adjacent to the development site.

A1.3 The parking spaces will be allocated on a 'first come, first served' basis in terms of paying the prescribed fee. Access to the car park will be strictly controlled by a combination of barriers and shutters. Entry will be facilitated by coded entry and/or number plate recognition which will permit registered vehicles only to enter.

Car Usage - Car Sharing

A1.4 Car sharing is also known as lift-sharing, car-pooling or ride-sharing. Car sharing offers people a cost effective and a more sustainable way of travelling by car when other forms of transport are not viable.

A1.5 Car sharing schemes encourage individuals to share private vehicles for particular journeys. Car sharing can be both formal and informal. Informal car sharing operates between individuals and neighbours and formal car sharing is defined by a more elaborate approach to trip matching, often focussed on the commuting journey.

A1.6 Car sharing would reduce a number of car trips and participants will meet other members in the community. A National Car Sharing database is now available at www.carsharing.ie. It is an all-island service for the public and is free of charge to use.

A1.7 The benefits of car sharing:

- reduces transport costs

- reduces the number of cars on the road which results in less pollution, less congestion and fewer parking issues
- reduces the need for a private car

A1.8 The residential development's community website would have a section dedicated to the car share scheme and the residents would have an option to register. To encourage take up of the car sharing, the MMP Coordinator would host events to introduce prospective car sharers to each other and would help 'break the ice' as it is always more likely that people will share, particularly for the journey 'home', with somebody that they have met rather than a complete stranger.

Car Usage - Car Club

A1.9 Car Clubs are membership-based schemes providing shared cars for hire. A Car Club can play an important role in reducing costs, congestion and environmental impact. Members have flexible access to the hire of a vehicle. Vehicles are parked in reserved parking spaces close to homes, town centres or workplaces and can be used and paid for on an hourly rate, daily or weekly basis. Individuals can join a car club or an organisation may have a corporate package with one of the car club providers.

A1.10 Car sharing clubs in Ireland have experienced significant growth in recent years. The facility allows members' access to a shared car in the local area for an hourly fee. This facility could be an attractive option for those who choose to start walking or cycling to work but may require access to a car at short notice. A GoCar Letter of Intent has been included in the Parking Strategy to guarantee the establish 2 no. GoCars at the residential development. Residents and visitors can obtain further information at www.gocar.ie. The benefits of such car sharing services include;

- the reduction of the number of cars on the road and therefore traffic congestion, noise and air pollution;
- minimising the demand for car parking and freeing up land traditionally used for private parking spaces, but which may not be used;
- increasing use of public transport, walking and cycling as the need for car ownership is reduced; and
- car sharing allows those who cannot afford a car the opportunity to drive, encouraging social inclusivity.

Public Transport

A1.11 The residential development will be well served by bus services operated by Bus Eireann, Ashbourne Connects, with routes passing the subject site on the Dublin Road R135. The bus stops are located in very close proximity with the closest bus stop at only 350m from the subject site with frequent inbound services operating daily

A1.12 Encouraging the residents to use public transport starts with awareness and promotion. People's perceptions of public transport may be based on outdated experiences, or even on hearsay. Marketing information can be effective in selling the public transport service to them.

A1.13 As well as providing information, part of the aim is to positively brand public transport, pointing out its advantages and attempting to reduce people's negative associations. The outcome of this is the importance of not encouraging people onto poor public transport, where negative experiences may further reinforce car preferences.

A1.14 The use of information points within the development is an effective method of increasing awareness among residents about public transport options. These 'points' are usually information stands containing the latest bus and rail timetables, route maps and other promotional material. The development's website can also be a conduit for this information, and can incorporate links to the bus operators' websites.

A1.15 A public transport information service can be offered to residents in which they have opportunity to register to receive public transport timetables for their preferred routes by email or text. Members are sent new timetables as they become available.

Walking

A1.17 The development has been designed to ensure that the development is permeable with a number of access points / gateways to facilitate walking through the site. The feasibility of measures that promote walking will be influenced by factors such as the safety and ease of walking to and from the site and the age profile of commuters. Generally speaking a distance of up to 4km is considered reasonable for walking. This distance is only indicative but can help to define target groups.

A1.18 The health benefits of walking are a key element in promoting Mobility Management Plans. Walking improves cardiovascular fitness and burns calories. Walking will also increase your muscle tone, boost metabolism, ease stress, raise energy levels and improve sleep, which combined can also help with weight loss. Regular walking can also reduce the risk of coronary heart disease, diabetes, strokes, high blood pressure, cancer, osteoporosis and arthritis.

A1.19 Walking will mainly be self-promoting and initiatives should focus on making people aware of the routes available to them. A map showing the walking routes should be prepared and placed at key locations within the development. These could be stand-alone signs or maps on notice boards. This information would also be available on the community website.

A1.20 It is important to ensure that pedestrians are safe and are satisfied with the facilities available and their maintenance. It should be noted that: -

- Walking is truly the most-sustainable form of transportation, and the world's first form of travel.
- All trips, regardless of mode, both begin and end on foot.
- Walking needs to have a greater level of priority in most cities, like walk-signal times, safer well-lit / marked crosswalks and pedestrian zones.
- Walking is an easy mode of travel for distances under 2km. Most people are prepared to walk between 800m to 1km to a train station or bus stop.

Cycling

A1.21 The residential development is well located for cycling journeys and this mode of travel should be encouraged with the provision of a wide range of routes within the development and new links to existing and future major routes in the local area. A distance of up to 10km is considered reasonable for cycling. This distance is only indicative but can help to define target groups.

A1.22 The on-site cycle facilities will be linked to the existing off-site cycle routes.

A1.23 As with many measures relating to cycling, the aim is a mixture of support, through incentives and facilities, and encouragement, through information and marketing. Incentives and facilities at both trip origin and destination / place of work, education, worship etc. can include some of the following. The MMP will highlight that many of these are available at trip end destinations:

- the provision of well-located high-quality cycle parking facilities including cargo bicycle parking at surface and basement level; and
- storage, changing and shower facilities for cyclists.

Appendix B

Management & Monitoring Measures

B1.0 MANAGEMENT & MONITORING MEASURES

B1.1 Introduction

B1.1.1 For the Mobility Management Plan to be successful, it is important that it is organised and managed well. The success of the Mobility Management Plan will also be subject to ongoing monitoring.

B1.2 Management Structure & Roles

B1.2.1 The appointment of a Mobility Manger / Group is critical to the success of the MMP. Both the BTR and BTS components of the site will be managed by a highly experienced management company, who will oversee and ensure a successful MMP.

B1.2.2 For the MMP to be successful it is essential that all residents take ownership of it. Therefore, as the development is being built out and the community becomes established it will become increasingly important for management responsibility to be supplemented by the local community residing at the subject development.

Mobility Manager

B1.2.3 A Mobility Manager will therefore be appointed prior to first occupation of the site. The Mobility Manager will be employed full-time and therefore be available full-time, but their role as a Mobility Manager will be part-time (i.e. he / she will be employed for other work in addition to mobility management). Their role will include leading the implementation, monitoring and review of the Plan.

B1.2.4 A MMP needs to be monitored, co-ordinated and marketed on a regular basis to ensure that it meets its objectives and its targets are achievable and realistic. The Mobility Manager is appointed to ensure the success of this plan. The primary duties of the Mobility Manager are:

- To develop and oversee the implementation of the initiatives outlined in the plan;
- To monitor progress of the plan;
- To promote and market the plan;
- To manage public transport discount fare schemes, cycle promotion schemes and events; and

- To provide “travel advice and information” to residents.

B1.2.5 To promote and manage the shift towards high level, public transport use, the MMP should be monitored, developed, promoted and managed by the Mobility Manager. The Mobility Manager should encourage and promote the measures mentioned within this report to the commuters of the development.

Residents Group

B1.2.6 As the development approaches full occupation; residents of the development will be invited to form a Residents Group.

B1.3 Monitoring

B1.3.1 Baseline conditions will be established as early as possible following 90% occupation of the development. Following the baseline survey, annual surveys will be undertaken until the development is fully occupied. By this time, it is expected that the travel patterns will have been established. A review of the trends in the MMP results would then be used to identify whether further monitoring is required.

B1.3.2 The Mobility Manager will be responsible for undertaking the monitoring, the processing of results and the production of the reports with the results of the findings.

B1.3.3 The monitoring will take place in the form of Travel Surveys. These will be carried out on the same day every year. It is recommended that the timing of the Travel Survey should take place in a neutral time of year i.e. Spring or Autumn.

B1.3.4 The survey would be in the form of a questionnaire that residents would complete. Communication of the Travel Survey will be through letters in the post or email. This letter will inform all residents of how to complete the survey online. Residents can also request a paper copy of the survey to be filled out by hand rather than electronically. However, the online method would be the preferred channel. The survey will include questions to allow the monitoring of the particular targets that have been set in the MMP.

B1.3.5 It is essential that the residents see the results of the survey and review their own travel patterns against the typical data. Therefore, the results should be available on the community website.

B1.3.6 The Mobility Manager will be responsible for the preparation of the annual monitoring reports. The objective of the review will be to assess the success of the MMP and to identify potential for future improvement.

B1.3.7 An important part of the review would be to revise information relating to public transport, cycling and walking routes to ensure that it is relevant and up-to-date. This is critical if residents are going to be able to rely on information when making travel choices.

B1.3.8 The annual reports will also include a review of where targets are being met and also identify potential changes to the measures implemented by the plan where targets are not being met. Specific short-term targets will be considered and agreed to ensure progress towards the overall target. Targets will also be revised to ensure that they remain appropriate and challenging.

Appendix C

Marketing & Promotion Measures

C1.0 MARKETING MEASURES

C1.1 Raising Awareness, Marketing & Promotion

C1.1.1 The education of residents on the Mobility Management Plan initiatives and the importance of contribution are very important. The services available to the residents must be communicated in a consistent and continuous manner to sustain behavioural change.

C1.1.2 Promotion would start with the marketing of the residential development. The sustainable location of the development and the high-quality infrastructure provision for walking and cycling will be a prominent feature. The high-quality links provided by Bus Eireann and AshbourneConnect to the various Employment Areas, City Centre and other links are also an attractive feature for encouraging sustainable travel for future residents.

C1.1.3 Communications will include promotional initiatives and activities aimed at informing the residents of all relevant external bodies of the existing and proposed transport networks. Such initiatives will include, but not limited to:

- Internal communications channels
- Advertising – local press and media
- Publicity – promotion of benefits

C1.2 Sustainable Travel Pack

C1.2.1 Promotion of sustainable travel will continue when residents take up occupation of their new accommodation. A 'Welcome Pack' can be provided which will include maps and timetable information for walking, cycling and public transport journeys. It will also include information on a range of incentives to encourage take up of public transport and cycling etc.

C1.2.2 The 'Welcome Pack' will be produced and approved prior to first occupation and staff will be trained in the contents of the information contained. The 'Welcome Pack' will include:

- A covering letter explaining the purpose of the 'Welcome Pack' and contact details of the Mobility Manager,
- An overview of the Mobility Management Plan,
- Maps for walking, cycling and public transport,

- Timetables for public transport (i.e. Bus Eireann, Ashbourne Connect),
- Local taxi information,
- Car sharing scheme information,
- Information on reducing the demand for travel,
- Sustainable travel voucher to encourage walking, cycling and public transport, and
- Pedometer pack with information on the health benefits of walking.

C1.2.3 Increasing awareness of alternative modes to car use and the benefits is a central component of mobility management. In particular, residents should be made aware of the benefits of active travel modes including health and financial benefits. Key actions might include:

- Establishing a clear brand concept for green / smarter travel to and from the site. This should be incorporated in all communication with the residents regarding commuting to and from the site;
- Provide a central information point for residents in relation to travel options, this should be a physical point within the development but should also be made available on the internet. The latter could also include information on bus and rail routes and timetables;
- New residents to the development should be informed about travel options;
- Ensure the residential development is included as a key destination on journey planning apps.

C1.3 Personalised Travel Plan

C1.3.1 An advisory leaflet will be provided in the 'Welcome Pack' to explain to new residents the sustainable transport options available in the MMP and that if they wish they may contact the Mobility Manager directly to discuss specific travel needs. The Mobility Manager will then use the information discussed to prepare a 'Personal Travel Plan' for that resident free of charge. The Personal Travel Plan will be based on individual lifestyles and in light of the available transport options for stated everyday journeys.

C1.3.2 This process will allow residents to consider how they currently travel and promote alternative methods for their journeys to work, school and when accessing other local amenities. Personalised journey planning will also enable

residents who might not otherwise use public transport realise there are local services available that can suit their needs.

C1.3.3 The Mobility Manager is responsible for promoting the availability of this measure and residents will be encouraged to contact the Mobility Manager if they have any specific sustainable travel related queries.

C1.4 Online Website

C1.4.1 A dedicated online website for the residential development may be created and will focus on providing appropriate, up-to-date information on sustainable travel options for accessing the development site.

C1.4.2 This website will act as a 'one-stop-shop' for the dissemination of site-wide sustainable travel information to residents, as well as acting as a source of information for visitors. Information on the website will include details of local public transport routes, local amenities and facilities, walking and cycle maps and a link to online car sharing opportunities. The website will also provide links to other websites such as Bus Eireann and Ashbourne Connect so as to encourage residents to plan their journeys using sustainable transport.

C1.5 Smart Device Travel App

C1.5.1 A Travel App could be developed for the residents at the development as well as visitors travelling to the site. This smart device app will enable all users to gain instant access to travel information. This may include:

- Timetables, location of stops, route information, fares, and real-time information for bus services
- Interactive map showing users current location and highlighting local points of interest (e.g. closest bus stop)
- Pedometer for walkers